

DRAWING LEGEND

- AREAS OF SLOPES =>30%
- AREAS OF SLOPES =15-30%
- WETLAND AREA
- 100' NYSDEC WETLAND BUFFER
- GOLF COURSE FAIRWAY, TEES, GREENS
- GOLF COURSE BUNKERS

NOTE:
THE LIMIT OF PROJECT DISTURBANCE LINE SHOWN HEREON DOES NOT INCLUDE THE DISTURBANCE CREATED BY THE REDEVELOPMENT OF THE PROPOSED GOLF COURSE. FOR CONVENIENCE PURPOSES THE LAYOUT OF THE GOLF COURSE IS SHOWN.

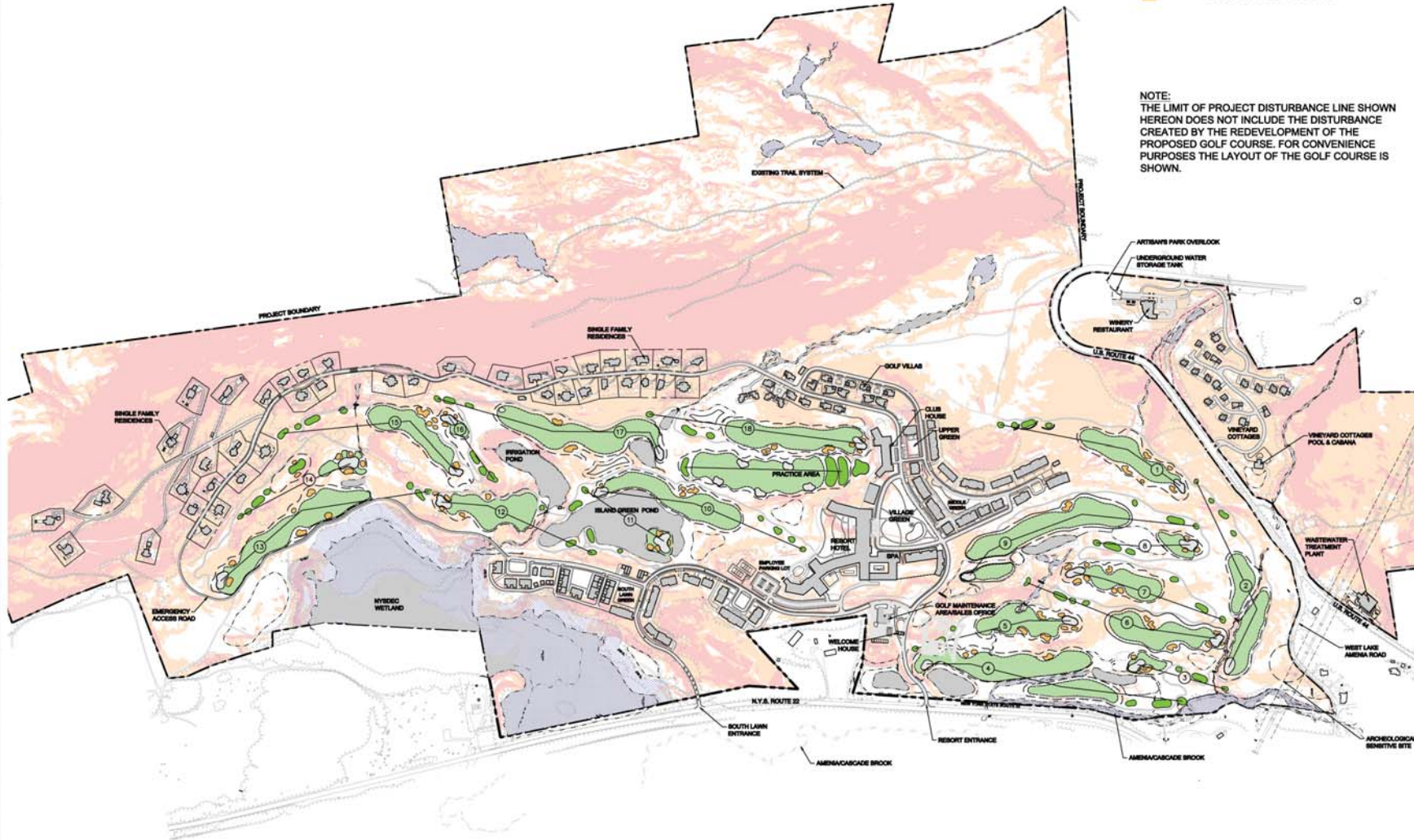

ARCHITECT OF RECORD - RESORT

J|f Jensen Fey
 phone 425.216.6318 fax 425.216.6329
 7730 Leary Way Redmond, WA 98052

ARCHITECT OF RECORD - RESIDENTIAL

MINNO & WASKO

SURVEY, PLANNING AND ENGINEERING

CHAZEN ENGINEERING, LAND SURVEYING & LANDSCAPE ARCHITECTURE CO., P.C.

GOLF COURSE ARCHITECT

ERNIE ELS DESIGN

NATURAL RESOURCE MANAGEMENT PLAN

AUDUBON INTERNATIONAL

WATER AND WASTEWATER TREATMENT FACILITIES

DELAWARE OPERATIONS, INC.

REVISIONS

NO.	REVISION	DATE
4	MASTER DEVELOPMENT PLAN FOR SPECIAL USE PERMIT	00-10-02
3	MASTER DEVELOPMENT PLAN FOR SPECIAL USE PERMIT	01-08-03
2	PRE-WORK MASTER DEVELOPMENT PLAN	09-19-02
1	MASTER DEVELOPMENT PLAN	04-03-02



SILO RIDGE RESORT COMMUNITY
AMENIA, NY

ROBERT A.M. STERN ARCHITECTS, LLP
 480 WEST 34th STREET, NEW YORK, NY 10001
 TEL: (212) 961-6100 - FAX: (212) 961-6084

HOBBS GROUND COUNTRY CLUB MANAGEMENT CO., LLC
 340 RIDGE COUNTRY CLUB
 P.O. BOX 88
 AMENIA, NY 12501

ENVIRONMENTAL CONSTRAINTS MAP

PROJECT NO.	DATE
104-003-018	04/20/08
CAD FILE NO.	DATE
17-1-007	
DRAWING NO.	

ENV-1