

- LEGEND:**
- OVERALL PROJECT BOUNDARY
  - PROPOSED BUILDINGS
  - PROPOSED PRIVATE ROAD
  - SWM PROPOSED STORMWATER MANAGEMENT BASIN
  - 16 PROPOSED GOLF GREEN AND FAIRWAY

**OPEN SPACE CALCULATION**

<b>NATURAL WOODLANDS/WETLANDS</b>	
OPEN SPACE 1	224.7 ACRES
OPEN SPACE 2	41.0 ACRES
OPEN SPACE 3	6.1 ACRES
OPEN SPACE 4	1.9 ACRES
OPEN SPACE 5	2.8 ACRES
OPEN SPACE 6	42.0 ACRES
<b>SUBTOTAL:</b>	<b>318.5 ACRES</b>
<b>FIELDS / MEADOWS / RE-VEGETATED OPEN SPACE</b>	
OPEN SPACE 7	8.2 ACRES
OPEN SPACE 8	3.7 ACRES
OPEN SPACE 9	30.7 ACRES
<b>SUBTOTAL:</b>	<b>42.6 ACRES</b>
<b>GOLF OPEN SPACE</b>	
OPEN SPACE 10	88.2 ACRES
OPEN SPACE 11	85.0 ACRES
OPEN SPACE 12	2.3 ACRES
<b>SUBTOTAL:</b>	<b>175.5 ACRES</b>
<b>TOTAL:</b>	<b>536.6 ACRES</b>

**PARCEL ACREAGE = 670.7 +/- ACRES**  
**OPEN SPACE = 536.6 +/- ACRES**  
**OPEN SPACE % = 80.0%**

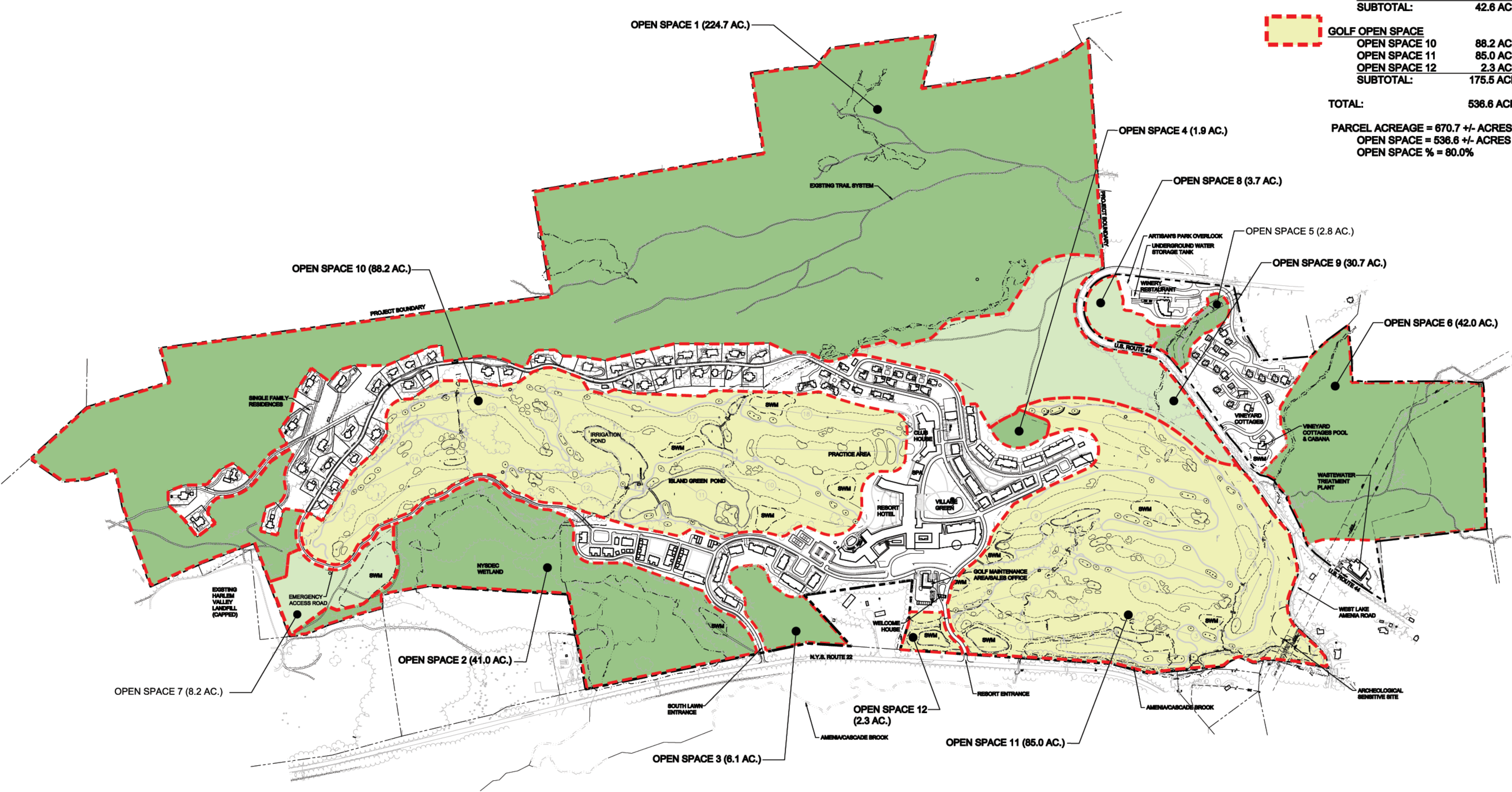

**ARCHITECT OF RECORD - RESORT**

**Jf Jensen Fey**  
 PHONE 425.216.0318 FAX 425.216.0329  
 7730 Leary Way, Redmond, WA 98052

**ARCHITECT OF RECORD - RESIDENTIAL**

**MINNO & WASKO**  
 ARCHITECTS AND PLANNERS  
 100 MARKET LANE, SUITE 100  
 LAMBERTVILLE, NY 12111  
 TEL: (518) 937-6400  
 FAX: (518) 937-6400

**SURVEY, PLANNING AND ENGINEERING**

**CHAZEN ENGINEERING, LAND SURVEYING**  
 & **LANDSCAPE ARCHITECTURE CO., P.C.**  
 2000 STATE STREET  
 SUITE 200  
 CANTON, NY 13616  
 TEL: (315) 487-1100  
 FAX: (315) 487-1100

**GOLF COURSE ARCHITECT**

**ERNIE ELS DESIGN**  
 1001 WOODLAND AVENUE, SUITE 110  
 WOODLAND, CA 95694  
 TEL: (916) 435-8000  
 FAX: (916) 435-8000

**NATURAL RESOURCE MANAGEMENT PLAN**

**AUDUBON INTERNATIONAL**  
 P.O. BOX 228  
 CANTON, NY 13613

**WATER AND WASTEWATER TREATMENT FACILITIES**

**DELAWARE OPERATIONS, INC**  
 100 WEST 10TH STREET  
 CHESTER, NY 13624  
 TEL: (315) 435-8000

**NOTES:**

No.	ISSUE	DATE
4	MASTER DEVELOPMENT PLAN FOR SPECIAL USE PERMIT	01-30-09
3	MASTER DEVELOPMENT PLAN FOR SPECIAL USE PERMIT	01-09-09
2	RE-ISSUE MASTER DEVELOPMENT PLAN	09-16-08
1	MASTER DEVELOPMENT PLAN	04-03-08

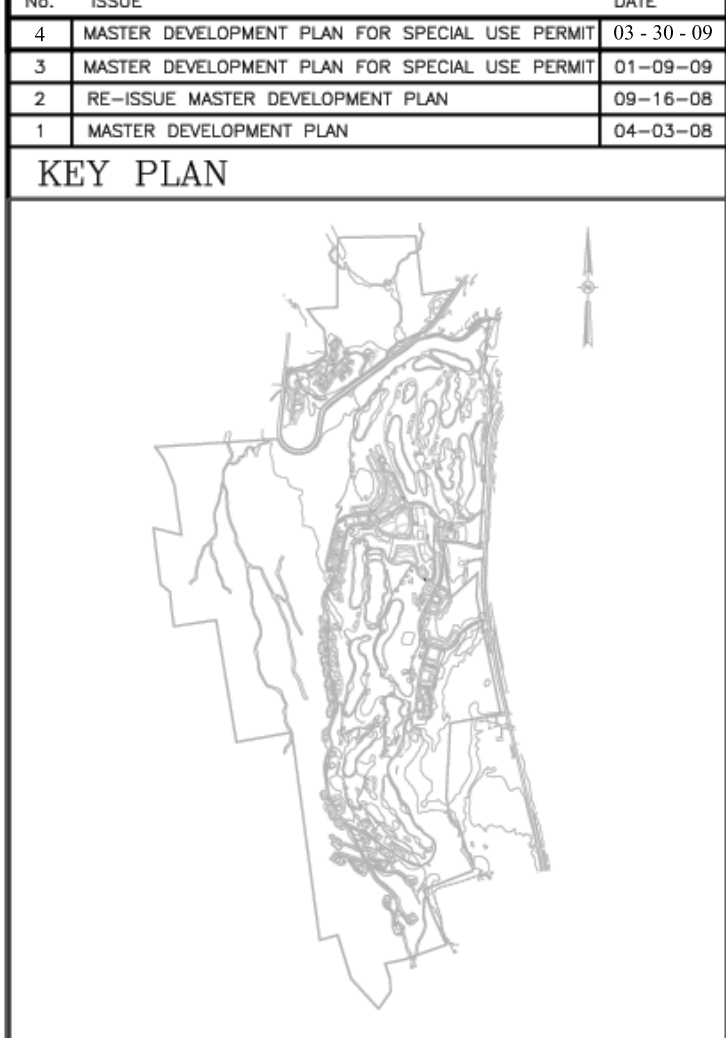

**SILORIDGE RESORT COMMUNITY**  
 AMENIA, NY

**ROBERT A.M. STERN ARCHITECTS, LLP**  
 460 WEST 34th STREET, NEW YORK, NY 10001  
 TEL: (212) 967-6100 • FAX: (212) 967-6688

**HIGHER GROUND COUNTRY CLUB MANAGEMENT CO., LLC**  
 SILORIDGE COUNTRY CLUB  
 P.O. BOX 88  
 AMENIA, NY 12501

**OPEN SPACE PLAN**

Project No.	Date
10454.02	04/03/08
CAD File No.	Scale
	1"=300'
Drawing No.	
<b>SP-5</b>	