

- PLANT PALETTE LEGEND**  
(SEE APPENDIX 1 OF THE HABITAT MANAGEMENT PLAN FOR PALETTE COMPOSITIONS)
- P0 AQUATIC HABITAT - LITTORAL SHELF GROUP
  - P1 AQUATIC HABITAT - SHORELINE GROUP
  - P2 NATIVE GRASS / FORB SPECIES GROUP ± 1' FOR IN-PLAY AREAS
  - P3 NATIVE GRASS / FORB SPECIES GROUP ± 1' FOR OUT-OF-PLAY AREAS
  - G1 TRANSITIONAL GRASSLANDS - P3 GROUP INTERSPERSED WITH P4 TREE AND SHRUB SPECIES
  - P4 TREE & SHRUB SPECIES - INCORPORATED INTO OUT-OF-PLAY AREAS WETLAND / MOIST AREAS AND UPLAND AREAS
  - P6 WETLAND SHELF AND EROSION CONTROL / RESTORATION GROUP FOR STORM WATER MANAGEMENT BASINS
  - HR HIGH ROUGH 4' - 8' IN HEIGHT BORDERING IN-PLAY WATER HAZARDS

- HABITAT CLASSIFICATION LEGEND**
- FOREST HABITAT
  - GRASSLAND AND SCRUB/SHRUB
  - WETLANDS
  - AQUATIC HABITAT / SWM POOLS & BASINS
  - GOLF COURSE
  - RESIDENTIAL AND COMMERCIAL DEVELOPMENT ZONE (INCLUDES LANDSCAPING)

- HABITAT ENHANCEMENT / BUFFER CLASSIFICATION SYSTEM**
- >5' TO <30' HABITAT ENHANCEMENT BOUNDARY
  - 30' WATER QUALITY BUFFER BOUNDARY
  - 30' - 100' BUFFER BOUNDARY

- CH** CONSERVATION BUFFERS  
Comprising ≥ 100 feet of undisturbed native terrestrial vegetation. More than 100 feet of undisturbed, functional native vegetation, with or without supplemental plantings.
- WQ** WATER QUALITY BUFFERS  
Comprising ≥ 30 feet of terrestrial vegetation. More than 30 feet of terrestrial vegetation, with or without supplemental plantings, may or may not include areas of undisturbed native vegetation.
- T** TERRESTRIAL HABITAT ENHANCEMENTS  
Comprising more than 5 feet and less than 30 feet of terrestrial vegetation. More than 5 feet of terrestrial vegetation, with or without supplemental plantings, may or may not include areas of undisturbed native vegetation.
- AQ** AQUATIC HABITAT ENHANCEMENTS  
Comprising up to 5 feet of terrestrial vegetation in combination with shoreline and/or emergent aquatic (perennial or littoral) vegetation.
- AW** STORM WATER IMPOUNDMENTS
- SWM** STORM WATER MANAGEMENT BASINS  
Comprising permanent wet pool, attenuation basin, and contiguous terrestrial habitat enhancements. A 5 to 30 foot habitat enhancement boundary originates from the permanent wet pool edge. SWM locations and habitat enhancement boundaries are pending adoption of final site-specific phasing and construction plan.

- MITIGATION STRUCTURES**
- BAC** BOTTOMLESS ARCHED OR OVER-SIZED BOX CULVERTS - oversized culverts that preserve aquatic and semi-aquatic substrata, natural, unconfined flow regime, and provide sufficient light infiltration and air dissolution to maintain an environment conducive to unrestricted animal movements along aquatic corridors.  
WET - for existing wetlands and streams.  
DRY - for intermittent flows and ephemeral waterways.
- GoB** GOLF COURSE FOOTCANT BRIDGES - abutment and approaches constructed outside of annual high water mark and functional stream bed (including stream banks).
- WT** WILDLIFE TUNNELS - roadway passages placed in known or potential animal migration pathway locations to link critical habitat features that are bisected by roadway construction.

**ARCHITECT OF RECORD - RESORT**  
**Jf** Jensen Fey  
PHONE 425.216.0318 FAX 425.216.0325  
7730 Leary Way, Redmond, WA 98052

**ARCHITECT OF RECORD - RESIDENTIAL**  
**MINNO & WASKO**  
ARCHITECTS AND PLANNERS  
11 LAMBERT LANE, SUITE 100  
LAURELHILL, WASH  
98036-4400  
PHONE 206.881.4400 FAX 206.881.4401

**SURVEY, PLANNING AND ENGINEERING**  
**CHAZEN ENGINEERING, LAND SURVEYING**  
**LANDSCAPE ARCHITECTURE CO., P.C.**  
10000 15th Avenue NW, Suite 100  
Bellevue, WA 98005  
Phone: (206) 835-3441 Fax: (206) 835-3442  
10000 15th Avenue NW, Suite 100  
Bellevue, WA 98005  
Phone: (206) 835-3441 Fax: (206) 835-3442

**GOLF COURSE ARCHITECT**  
**ERNIE ELS DESIGN**  
10000 15th Avenue NW, Suite 100  
Bellevue, WA 98005  
Phone: (206) 835-3441 Fax: (206) 835-3442

**NATURAL RESOURCE MANAGEMENT PLAN**  
**AUDUBON INTERNATIONAL**  
2000 15th Avenue NW, Suite 100  
Bellevue, WA 98005  
Phone: (206) 835-3441 Fax: (206) 835-3442

**WATER AND WASTEWATER TREATMENT FACILITIES**  
**DELAWARE OPERATIONS, INC.**  
10000 15th Avenue NW, Suite 100  
Bellevue, WA 98005  
Phone: (206) 835-3441 Fax: (206) 835-3442

**NOTES:**  
Maximum water quality buffer limits are not identified for SWM 3. SWM 3 will be removed to a new location outside of the Arden/Cascade Brook floodplain (in the vicinity of Holes 3 and 4) during final modifications to the Master Development Plan (MDP) for the site. This new location is expected to provide for a minimum of 30 feet of water quality buffer around the entire perimeter of the SWM. Modifications to the placement of SWM and subsequent adjustments to the Buffer Management Plan will be incorporated into the MDP during the Special Permit process.

**KEY PLAN**  
A map showing the location of the project area within a larger regional context.

**SILO RIDGE RESORT COMMUNITY**  
AMENIA, NY

**ROBERT A.M. STERN ARCHITECTS, LLP**  
460 WEST 34th STREET, NEW YORK, NY 10001  
TEL: (212) 907-5100 FAX: (212) 907-5068

**HIGHER GROUND COUNTRY CLUB MANAGEMENT CO., LLC**  
SILVER COUNTRY CLUB  
P.O. BOX 88  
AMENIA, NY 13501

**HABITAT MANAGEMENT PLAN**  
**BUFFERING PLAN - NORTH**

Project No. 10454.02 Date 04/03/08  
Scale 1"=100'  
Drawing No. ENV-4

Copyright (c) 2006 Robert A.M. Stern Architects

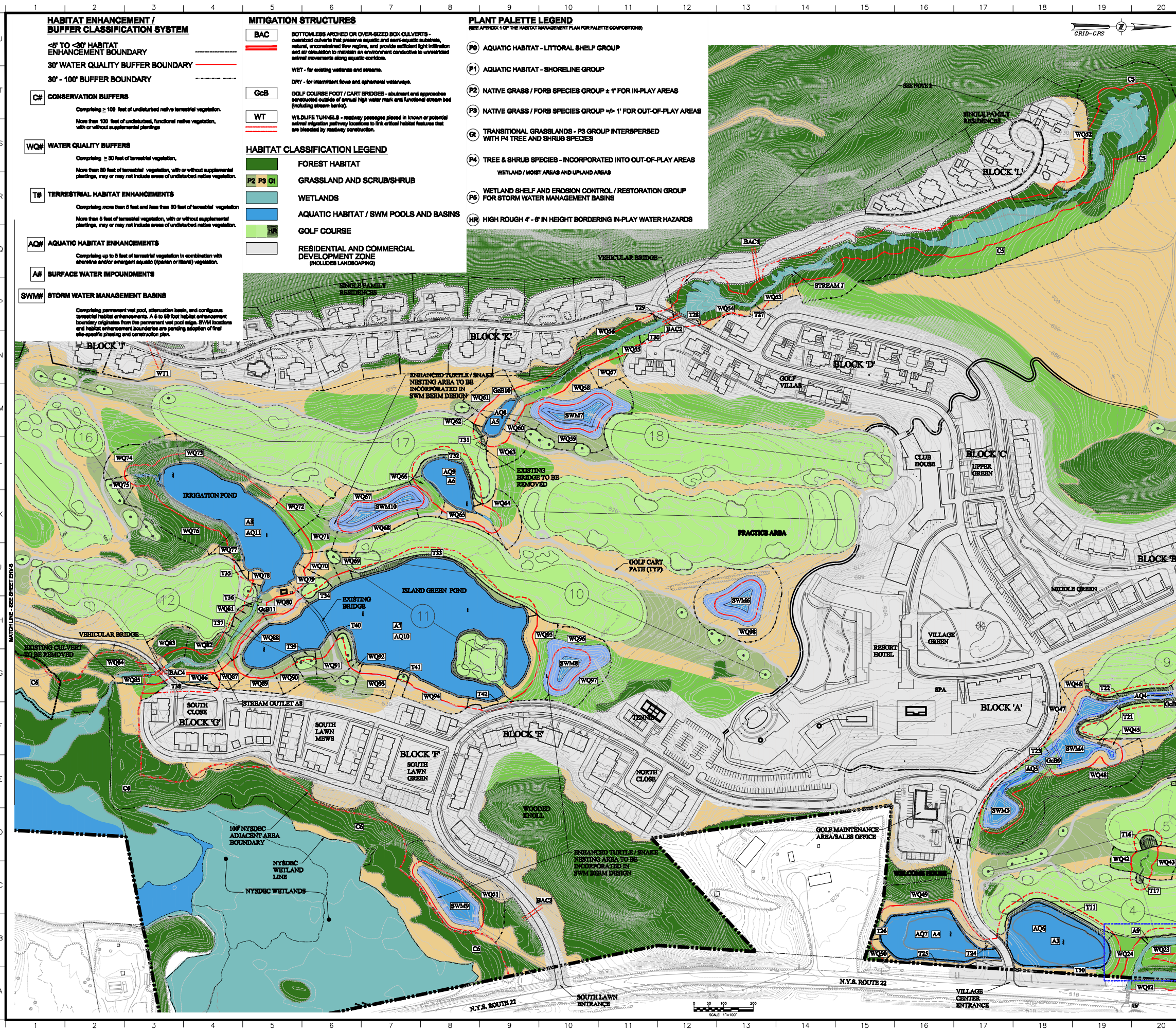

**HABITAT ENHANCEMENT / BUFFER CLASSIFICATION SYSTEM**

<5' TO <30' HABITAT ENHANCEMENT BOUNDARY  
30' WATER QUALITY BUFFER BOUNDARY  
30' - 100' BUFFER BOUNDARY

- C6 CONSERVATION BUFFERS**  
Completing ≥ 100 feet of undisturbed native terrestrial vegetation.  
More than 100 feet of undisturbed, functional native vegetation, with or without supplemental plantings
- WQ4 WATER QUALITY BUFFERS**  
Completing ≥ 30 feet of terrestrial vegetation, with or without supplemental plantings, may or may not include areas of undisturbed native vegetation.
- T8 TERRESTRIAL HABITAT ENHANCEMENTS**  
Completing more than 5 feet and less than 30 feet of terrestrial vegetation, with or without supplemental plantings, may or may not include areas of undisturbed native vegetation.
- AQ3 AQUATIC HABITAT ENHANCEMENTS**  
Completing up to 5 feet of terrestrial vegetation in combination with shoreline and/or emergent aquatic (partial or littoral) vegetation.
- A8 SURFACE WATER IMPOUNDMENTS**
- SWM6 STORM WATER MANAGEMENT BASINS**  
Completing permanent wet pool, retention basin, and contiguous terrestrial habitat enhancements. A 5 to 80 foot habitat enhancement boundary originates from the permanent wet pool edge. SWM locations and habitat enhancement boundaries are pending adoption of final site-specific planning and construction plans.

**MITIGATION STRUCTURES**

- BAC**  
BOTTOMLESS ARCHED OR OVER-SIZED BOX CULVERTS - oversized culverts that preserve aquatic and semi-aquatic substrate, natural, unconfined flow regime, and provide sufficient light infiltration and air circulation to maintain an environment conducive to unrestricted animal movements along aquatic corridors.
- GcB**  
GOLF COURSE FOOT / CART BRIDGES - abutment and approaches constructed outside of annual high water mark and functional stream bed (including stream banks).
- WT**  
WILDLIFE TUNNELS - roadway passages placed in known or potential animal migration pathway locations to link critical habitat features that are blocked by roadway construction.

**HABITAT CLASSIFICATION LEGEND**

- FOREST HABITAT**
- GRASSLAND AND SCRUB/SHRUB**
- WETLANDS**
- AQUATIC HABITAT / SWM POOLS AND BASINS**
- GOLF COURSE**
- RESIDENTIAL AND COMMERCIAL DEVELOPMENT ZONE (INCLUDES LANDSCAPING)**

**PLANT PALETTE LEGEND**

- (P0) AQUATIC HABITAT - LITTORAL SHELF GROUP**
- (P1) AQUATIC HABITAT - SHORELINE GROUP**
- (P2) NATIVE GRASS / FORB SPECIES GROUP ± 1' FOR IN-PLAY AREAS**
- (P3) NATIVE GRASS / FORB SPECIES GROUP ± 1' FOR OUT-OF-PLAY AREAS**
- (G1) TRANSITIONAL GRASSLANDS - P3 GROUP INTERSPERSED WITH P4 TREE AND SHRUB SPECIES**
- (P4) TREE & SHRUB SPECIES - INCORPORATED INTO OUT-OF-PLAY AREAS WETLAND / MOST AREAS AND UPLAND AREAS**
- (P6) WETLAND SHELF AND EROSION CONTROL / RESTORATION GROUP FOR STORM WATER MANAGEMENT BASINS**
- (HR) HIGH ROUGH 4' - 6' IN HEIGHT BORDERING IN-PLAY WATER HAZARDS**

**ARCHITECT OF RECORD - RESORT**

**Jf** Jensen Fey  
PHONE 425.216.0318 FAX 425.216.0325  
7730 Leary Way, Redmond, WA 98052

**ARCHITECT OF RECORD - MINNO & WASKO**

**MINNO & WASKO**  
ARCHITECTS AND PLANNERS  
11 LAMBERT LANE, SUITE 100  
LAKEVILLE, MINN 56150  
TEL 952.466.4400 FAX 952.466.4401

**SURVEY, PLANNING AND ENGINEERING**

**CHAZEN ENGINEERING, LAND SURVEYING**  
**LANDSCAPE ARCHITECTURE CO., P.C.**  
CHAZEN ENGINEERING, LAND SURVEYING  
10000 15TH AVE. N. SUITE 100  
MINNETONKA, MN 55345  
TEL 952.895.4400 FAX 952.895.4401

**GOLF COURSE ARCHITECT**

**ERNIE ELS DESIGN**  
10000 15TH AVE. N. SUITE 100  
MINNETONKA, MN 55345  
TEL 952.895.4400 FAX 952.895.4401

**NATURAL RESOURCE MANAGEMENT PLAN**

**AUDUBON INTERNATIONAL**  
10000 15TH AVE. N. SUITE 100  
MINNETONKA, MN 55345  
TEL 952.895.4400 FAX 952.895.4401

**WATER AND WASTEWATER TREATMENT FACILITIES**

**DELAWARE OPERATIONS, INC.**  
10000 15TH AVE. N. SUITE 100  
MINNETONKA, MN 55345  
TEL 952.895.4400 FAX 952.895.4401

**NOTES:**  
Maximum water quality buffer widths are not identified for the west bank of Stream J. Modifications to the number and location of the individual residential units in Block L and adjustments to the length and location of the roadway leading to these units will be included in the Master Development Plan (MDP) for the site. These adjustments will provide for habitat protection in the housewarming area of the Stream/J. The site will be developed with a combination of conservation and water quality buffers. Further downstream, a minimum of 60 feet of water quality buffers will be established in association with modified roadway construction. Modifications to the placement of Block L residential units and the associated access road, and subsequent adjustments to the Buffer Management Plan, will be incorporated into the MDP during the Special Permit process.

No.	ISSUE	DATE
1	MASTER DEVELOPMENT PLAN	08-22-08

**KEY PLAN**

**SILO RIDGE RESORT COMMUNITY**  
AMENIA, NY

**ROBERT A.M. STERN ARCHITECTS, LLP**  
480 WEST 34th STREET, NEW YORK, NY 10001  
TEL (212) 907-5100 FAX (212) 907-5055

**HIGHER GROUND COUNTRY CLUB MANAGEMENT CO., LLC**  
SILVER COUNTRY CLUB  
P.O. BOX 88  
AMENIA, NY 12501

**HABITAT MANAGEMENT PLAN**  
**BUFFERING PLAN - CENTER**

Project No.	Date
10454.02	04/03/08

CD File No.	Scale
	1"=100'

Drawing No. **ENV-5**

Copyright (c) 2008 Robert A.M. Stern Architects

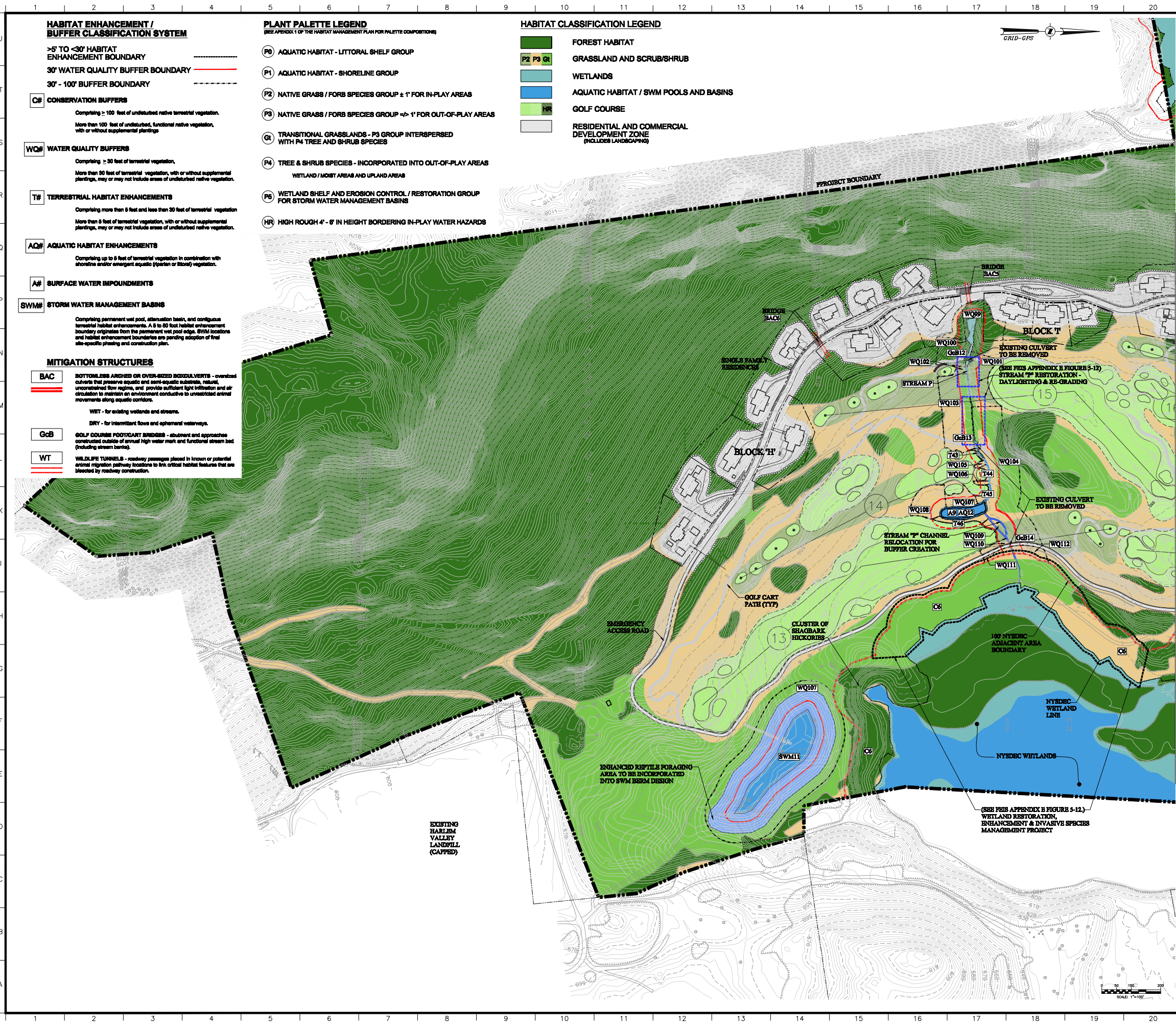

**HABITAT ENHANCEMENT / BUFFER CLASSIFICATION SYSTEM**

- >5' TO <30' HABITAT ENHANCEMENT BOUNDARY
- 30' WATER QUALITY BUFFER BOUNDARY
- 30' - 100' BUFFER BOUNDARY

- CH** CONSERVATION BUFFERS
  - Comprising ≥ 100 feet of undisturbed native terrestrial vegetation.
  - More than 100 feet of undisturbed, functional native vegetation, with or without supplemental plantings
- WQH** WATER QUALITY BUFFERS
  - Comprising ≥ 90 feet of terrestrial vegetation.
  - More than 90 feet of terrestrial vegetation, with or without supplemental plantings, may or may not include areas of undisturbed native vegetation.
- TH** TERRESTRIAL HABITAT ENHANCEMENTS
  - Comprising more than 5 feet and less than 30 feet of terrestrial vegetation
  - More than 5 feet of terrestrial vegetation, with or without supplemental plantings, may or may not include areas of undisturbed native vegetation.
- AQH** AQUATIC HABITAT ENHANCEMENTS
  - Comprising up to 5 feet of terrestrial vegetation in combination with shoreline and/or emergent aquatic (hyacinth or lily) vegetation.
- AW** SURFACE WATER IMPOUNDMENTS
- SWM** STORM WATER MANAGEMENT BASINS
  - Comprising permanent wet pool, attenuation basin, and contiguous terrestrial habitat enhancements. A 5 to 50 foot habitat enhancement boundary originates from the permanent wet pool edge. SWM locations and habitat enhancement boundaries are pending adoption of final site-specific phasing and construction plan.

**MITIGATION STRUCTURES**

- BAC** BOTTOMLESS ARCHES OR OVER-SIZED BOX-CULVERTS - oversized culverts that preserve aquatic and semi-aquatic substrata, natural, unconfined flow regime, and provide sufficient light infiltration and air circulation to maintain an environment conducive to unassisted animal movements along aquatic corridors
  - WET - for existing wetlands and streams.
  - DRY - for intermittent flows and ephemeral waterways.
- GcB** GOLF COURSE FOOTCART BRIDGES - abutment and approaches constructed outside of annual high water mark and functional stream bed (including stream banks).
- WT** WILDLIFE TUNNELS - roadway passages placed in known or potential animal migration pathway locations to link critical habitat features that are blocked by roadway construction.

**PLANT PALETTE LEGEND**

(SEE APPENDIX 1 OF THE HABITAT MANAGEMENT PLAN FOR PALETTE COMPOSITIONS)

- P0** AQUATIC HABITAT - LITTORAL SHELF GROUP
- P1** AQUATIC HABITAT - SHORELINE GROUP
- P2** NATIVE GRASS / FORB SPECIES GROUP ± 1' FOR IN-PLAY AREAS
- P3** NATIVE GRASS / FORB SPECIES GROUP ± 1' FOR OUT-OF-PLAY AREAS
- G1** TRANSITIONAL GRASSLANDS - P3 GROUP INTERSPERSED WITH P4 TREE AND SHRUB SPECIES
- P4** TREE & SHRUB SPECIES - INCORPORATED INTO OUT-OF-PLAY AREAS WETLAND / MOIST AREAS AND UPLAND AREAS
- P6** WETLAND SHELF AND EROSION CONTROL / RESTORATION GROUP FOR STORM WATER MANAGEMENT BASINS
- HR** HIGH ROUGH 4' - 8' IN HEIGHT BORDERING IN-PLAY WATER HAZARDS

**HABITAT CLASSIFICATION LEGEND**

- FOREST HABITAT
- GRASSLAND AND SCRUB/SHRUB
- WETLANDS
- AQUATIC HABITAT / SWM POOLS AND BASINS
- GOLF COURSE
- RESIDENTIAL AND COMMERCIAL DEVELOPMENT ZONE (INCLUDES LANDSCAPING)

ARCHITECT OF RECORD - RESORT

**Jf** Jensen Fey  
PHONE 425.216.0318 FAX 425.216.0325  
7730 Leary Way, Redmond, WA 98052

ARCHITECT OF RECORD - RESIDENTIAL

**MINNO & WASKO**  
ARCHITECTS AND PLANNERS  
11 LAMBERTVILLE, PENNSYLVANIA  
761.969.9999  
www.minnowasko.com

SURVEY, PLANNING AND ENGINEERING

CHAZEN ENGINEERING, LAND SURVEYING & LANDSCAPE ARCHITECTURE CO., P.C.  
CHAZEN ENGINEERING, LAND SURVEYING & LANDSCAPE ARCHITECTURE CO., P.C.  
CHAZEN ENGINEERING, LAND SURVEYING & LANDSCAPE ARCHITECTURE CO., P.C.  
CHAZEN ENGINEERING, LAND SURVEYING & LANDSCAPE ARCHITECTURE CO., P.C.

GOLF COURSE ARCHITECT

**ERNIE ELS DESIGN**  
1000 WILSON AVENUE, SUITE 100  
SILVER SPRING, MARYLAND 20910

NATURAL RESOURCE MANAGEMENT PLAN

AUDUBON INTERNATIONAL  
JULIE ANN DODD  
CHAZEN, PENNSYLVANIA

WATER AND WASTEWATER TREATMENT FACILITIES

DELAWARE OPERATIONS, INC.  
PO BOX 1000  
CHESAPEAKE, VIRGINIA 23020  
757.599.4000

NOTES:

No.	ISSUE	DATE
1	MASTER DEVELOPMENT PLAN	08-22-08

KEY PLAN

**SILLO RIDGE RESORT COMMUNITY**  
AMENIA, NY

**ROBERT A.M. STERN ARCHITECTS, LLP**  
480 WEST 34th STREET, NEW YORK, NY 10001  
TEL: (212) 907-5100 FAX: (212) 907-5068

**HIGHER GROUND COUNTRY CLUB MANAGEMENT CO., LLC**  
SILLO RIDGE COUNTRY CLUB  
P.O. BOX 88  
AMENIA, NY 13501

**HABITAT MANAGEMENT PLAN**  
**BUFFERING PLAN - SOUTH**

Project No.	Date
10454-02	04/03/08

CAD File No.	Scale
	1"=100'

Drawing No.
ENV-6

Copyright (c) 2008 Robert A.M. Stern Architects