

Match Line

See Sheet C5.08

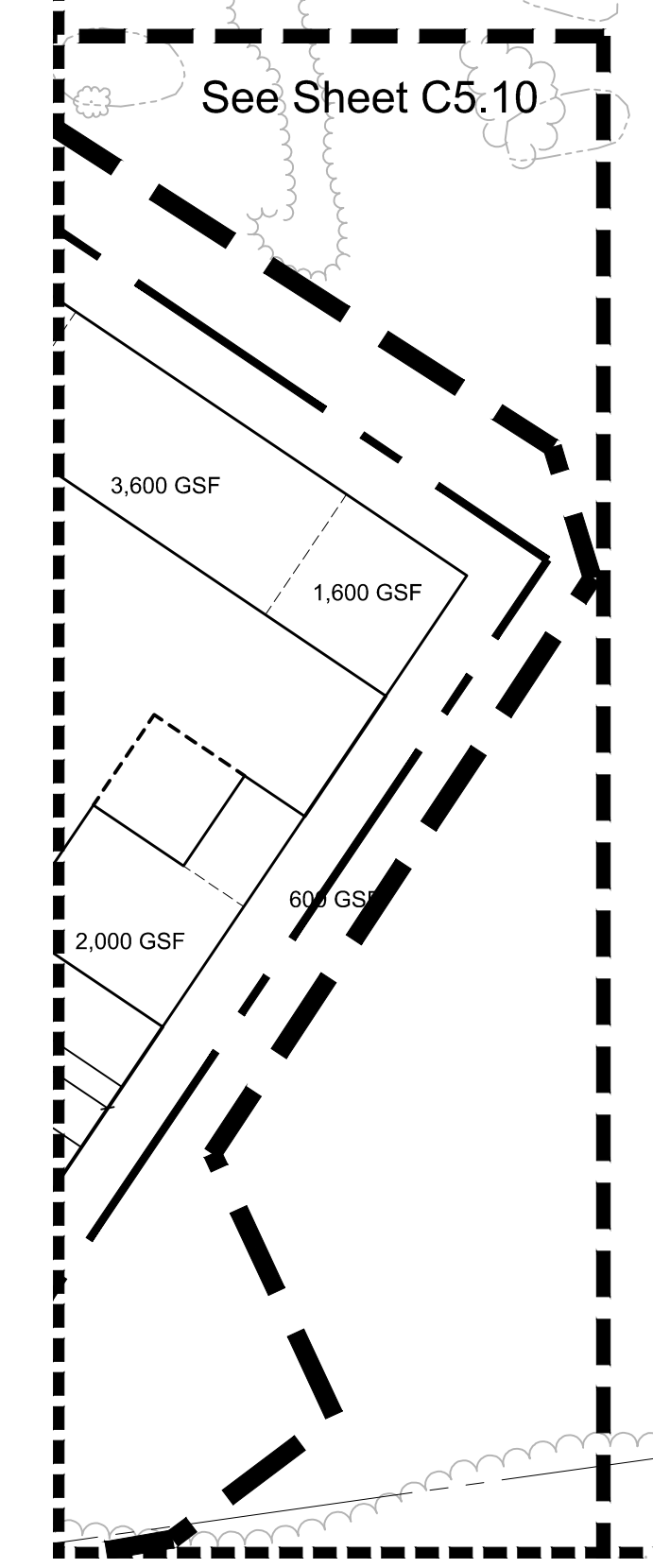
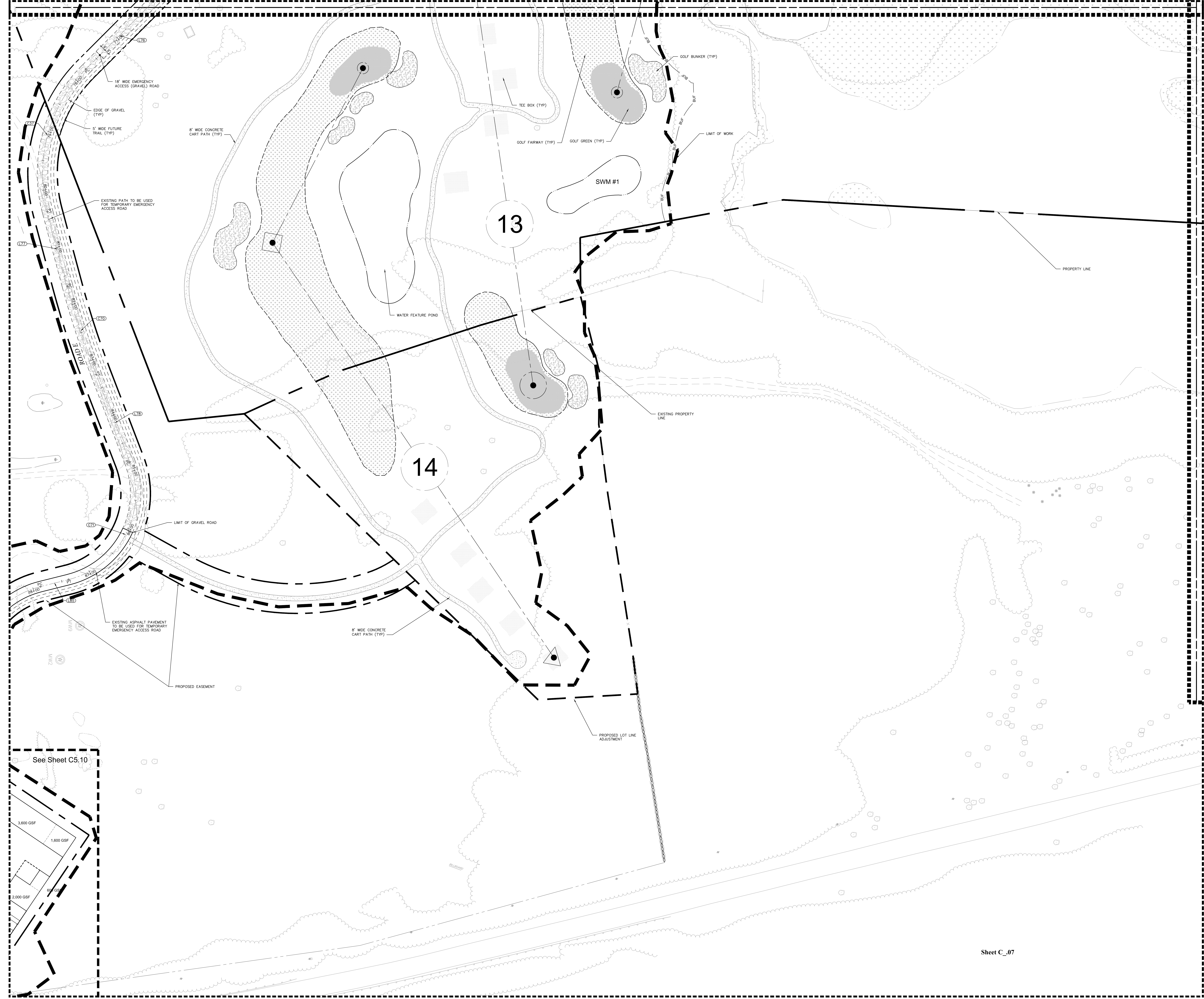

OWNER:
Silo Ridge Ventures, LLC
5021 Route 44
Amenia, New York 12501
845.373.8020

ARCHITECTS, PLANNERS, LANDSCAPE ARCHITECTS:
HART | HOWERTON
10 East 40th Street New York, NY 10016
Tel: 212.683.5611 Fax: 212.481.3768
E-mail: info@hart-howerton.com

GOLF COURSE DESIGNERS:
FAZIO DESIGN
401 N. Main St., Ste. 400
Hendersonville, North Carolina 28792
828.693.0052 • FAX 828.693.0071

ENVIRONMENTAL PLANNING & CIVIL ENGINEERING:
VHB
Engineering, Surveying & Landscape Architecture, PC
Planning
Transportation
Land Development
Environmental Services
50 Main Street, Suite 360
White Plains, New York 10606
914.467.6600 • FAX 914.761.3759

WASTEWATER AND WATER DESIGN:
CEDARWOOD ENGINEERING SERVICES, PLLC
CIVIL & ENVIRONMENTAL ENGINEERING
8-12 Dietz St., Suite 303
Oswego, NY 14127-3073
248 Main St., PO Box 203
North Creek, NY 518.251.5160

PROJECT SURVEYOR:
Kirk K. Horton, Land Surveyor
NYS License No. 049954
9 Broadway
Amenia, New York 12501
845.373.7809

KEY MAP:
N

SCALE IN FEET
0 50 100

| No. | Revision | Date | Prep'd |
|-----|----------|------|--------|
| | | | |

Designed by **JC** Drawn by **CMG** Checked by **MWJ**
CAD checked by **MB** Approved by **ACD**
Date: **As Shown** Date: **March 3, 2014**

Project Title:
Silo Ridge Resort Community
4651 Route 22
Amenia, New York
Issued for:
Site Plan - Phase 1

Not Issued for Construction
Project Title:
Site Layout Plan 7

Sheeting Number:
C5.07
Sheet 29 of 29
Project Number 29011.00

29011.00-PT_LM.DWG

See Sheet C5.05

Match Line

Sheet C_07