

MAINTENANCE FACILITY PLAN

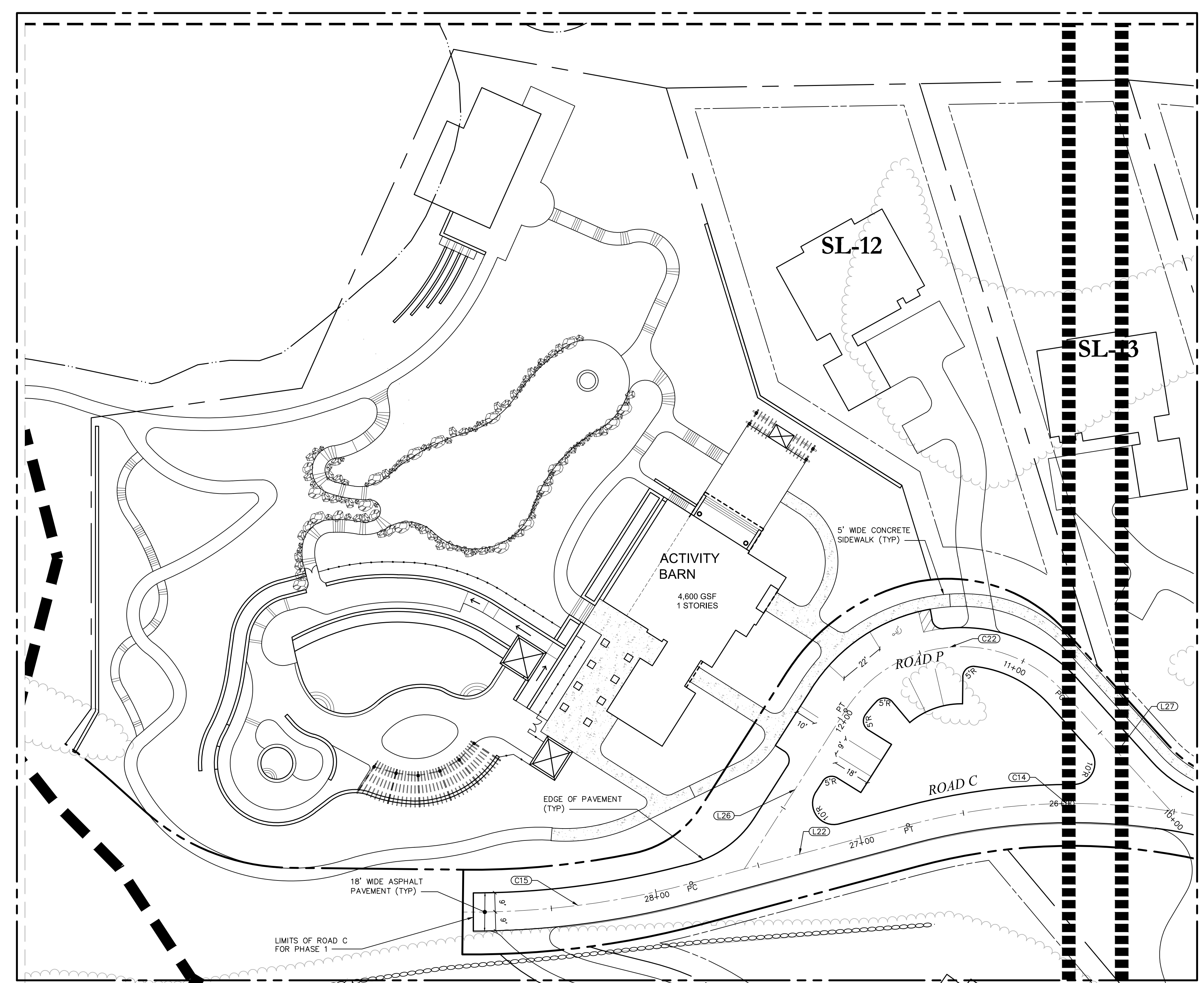

ACTIVITY BARN PLAN

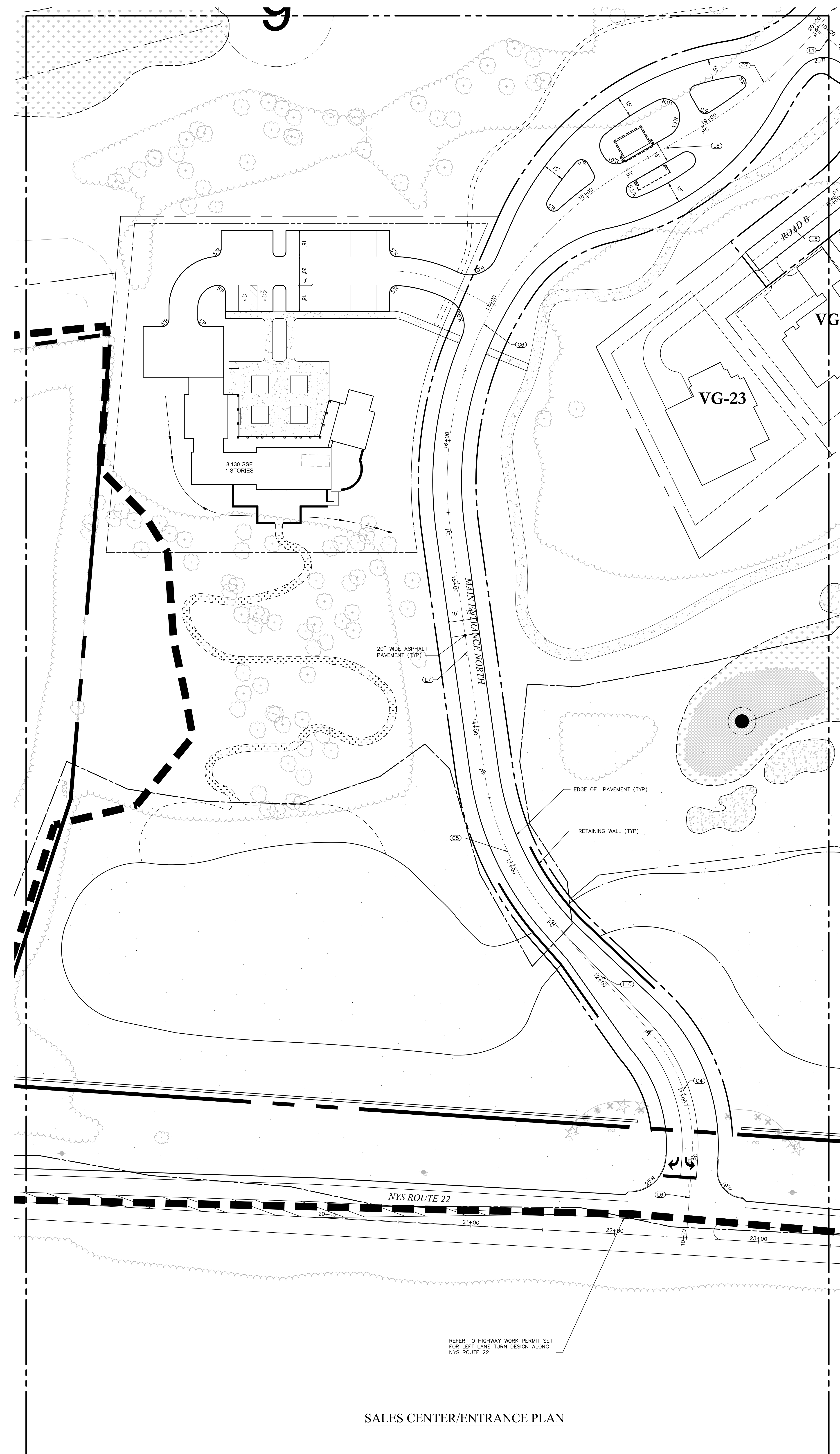

SALES CENTER/ENTRANCE PLAN

**OWNER:**  
Silo Ridge Ventures, LLC  
5021 Route 44  
Amenia, New York 12501  
845.373.8020

**ARCHITECTS, PLANNERS, LANDSCAPE ARCHITECTS:**  
HART | HOWERTON  
10 East 40th Street New York, NY 10016  
Tel: 212.683.5631 Fax: 212.481.3768  
Email: NY@hhowerton.com

**GOLF COURSE DESIGNERS:**  
**FAZIO DESIGN**  
401 N. Main St., Ste. 400  
Hendersonville, North Carolina 28792  
828.693.0052 • FAX 828.693.0071

**ENVIRONMENTAL PLANNING & CIVIL ENGINEERING:**  
**VHB**  
**Engineering, Surveying & Landscape Architecture, PC**  
Planning  
Transportation  
Land Development  
Environmental Services  
50 Main Street, Suite 360  
White Plains, New York 10606  
914.467.6600 • FAX 914.761.3759

**WASTEWATER AND WATER DESIGN:**  
**CEDARWOOD ENGINEERING SERVICES, PLLC**  
CIVIL & ENVIRONMENTAL ENGINEERING  
8-12 Dues St., Suite 303  
Oneonta, NY 14857-4232-3073  
248 Main St., PO Box 203  
North Creek, NY 518.251.5160

**PROJECT SURVEYOR:**  
Kirk K. Horton, Land Surveyor  
NYS License No. 049954  
9 Broadway  
Amenia, New York 12501  
845.373.7809

**KEY MAP:**  
N  
[Key Map Diagram]  
30 0 30 60  
SCALE IN FEET

No.	Revision	Date	Prepared
1	As Shown	March 3, 2014	MB

**Silo Ridge Resort Community**  
4651 Route 22  
Amenia, New York  
Issued for:  
Site Plan - Phase 1

Not Issued for Construction  
Drawing Title:  
Site Layout  
Plan 10

Drawing Number:  
**C5.10**  
Sheet 32 of 32  
Project Number:  
29011.00

29011.00-PT\_1.MXD

See Thursday, February 27, 2014 3:42:19 PM: BROUENBERG\_Planet Thursday, February 27, 2014 4:31:47 PM: Roseberry, David