

Match Line

See Sheet C7.04

See Sheet C7.05

10

See Sheet C7.10

See Sheet C7.01

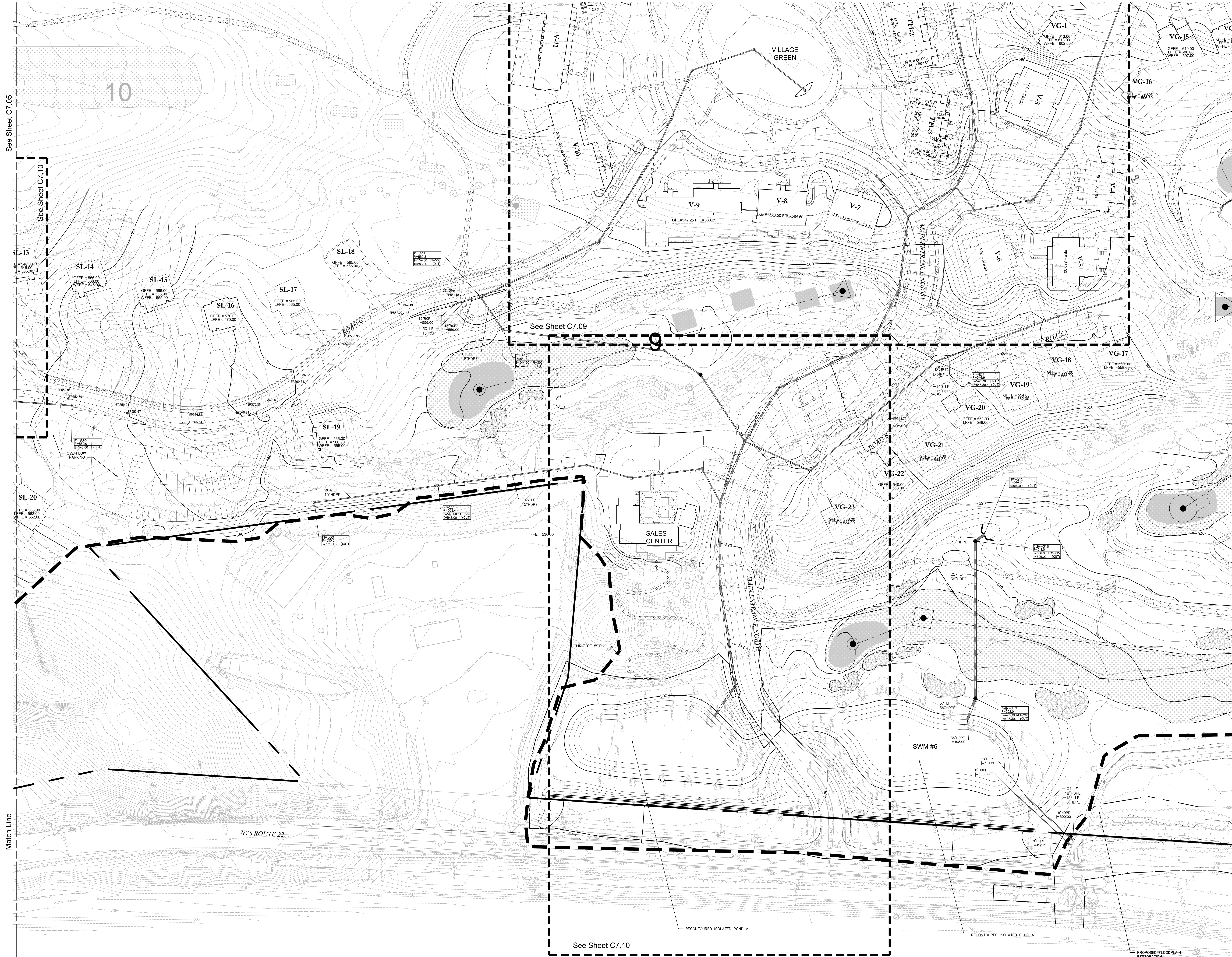

See Sheet C7.09

See Sheet C7.10

OWNER:  
**Silo Ridge Ventures, LLC**  
 5021 Route 44  
 Amenia, New York 12501  
 845.373.8020

ARCHITECTS, PLANNERS, LANDSCAPE ARCHITECTS:  
**HART | HOWERTON**  
 10 East 4th Street, New York, NY 10016  
 Tel: 212.683.5631 Fax: 212.481.3768  
 Email: NY@hart-howerton.com

GOLF COURSE DESIGNERS:  
**FAZIO DESIGN**  
 401 N. Main St., Ste. 400  
 Hendersonville, North Carolina 28792  
 828.693.0052 • FAX 828.693.0071

ENVIRONMENTAL PLANNING & CIVIL ENGINEERING:  
**VHB**  
**Engineering, Surveying & Landscape Architecture, PC**  
 Planning  
 Transportation  
 Land Development  
 Environmental Services  
 50 Main Street, Suite 360  
 White Plains, New York 10606  
 914.467.6600 • FAX 914.761.3759

WASTEWATER AND WATER DESIGN:  
**CEDARWOOD ENGINEERING SERVICES, PLLC**  
 CIVIL & ENVIRONMENTAL ENGINEERING  
 8-12 Dues St., Suite 303  
 Oneonta, NY 10757-4323  
 248 Main St., PO Box 203  
 North Creek, NY 518.251.5160

PROJECT SURVEYOR:  
**Kirk K. Horton, Land Surveyor**  
 NYS License No. 049954  
 9 Broadway  
 Amenia, New York 12501  
 845.373.7809

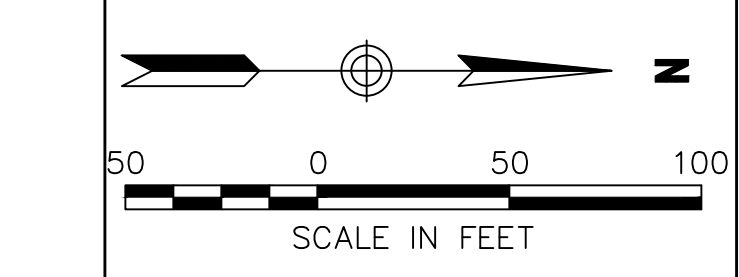

No.	Revision	Date	By

Designed by **JC** Drawn by **CMG** Checked by **MWJ**  
 CAD checked by **MB** Approved by **ACD**  
 Date: **As Shown** Date: **March 3, 2014**

Project Title:  
**Silo Ridge Resort Community**  
 4651 Route 22  
 Amenia, New York  
 Project No.:  
**Site Plan - Phase 1**

Not Issued for Construction  
 Project Title:  
**Grading and Drainage Plan 3**

Sheet Number:  
**C7.03**  
 of  
 43  
 Project Number:  
 29011.00