

- Notes:**
1. REFER TO CIVIL SITE DETAILS FOR EROSION AND SEDIMENT CONTROL DETAILS.
 2. REFER TO TEMPORARY SEDIMENT BASIN PLANS FOR ENLARGEMENTS OF EACH BASIN GRADING.
 3. REFER TO CONSTRUCTION SEDIMENTATION PLANS AND NOTES FOR DETAILS OF CONSTRUCTION PHASING. ADDITIONAL EROSION CONTROL MEASURES SHALL BE IMPLEMENTED AS NECESSARY AND IN ACCORDANCE WITH EROSION CONTROL NOTES AND SEDIMENT CONTRACTOR IS RESPONSIBLE TO MAINTAIN EROSION CONTROL MEASURES FOR PHASE.
 4. TEMPORARY SILT FENCE IS SHOWN AS APPROXIMATE. CONTRACTOR TO INSTALL AT TOE OF SLOPES IN ORDER TO MAINTAIN EROSION AND SEDIMENT CONTROL. ALL EXISTING WATER BODIES SHALL BE PROTECTED BY DOUBLE ROW SILT FENCE.
 5. TREE PROTECTION SHALL BE INSTALLED AT ALL TREES TO REMAIN WITHIN PROJECT LIMITS.
 6. EROSION BLANKET SHALL APPLY TO SLOPE GREATER THAN 4:1.

E&SC Legend:

	STORM DRAIN INLET PROTECTION AS PER APPROVED NYS STANDARDS AND SPECIFICATIONS FOR EROSION AND SEDIMENT CONTROL.
	SILT FENCE
	STRAW BALE
	SOIL STOCKPILE AREA
	TEMPORARY DIVERSION SWALE
	RPRAP PROTECTION
	STABILIZED CONSTRUCTION ENTRANCE

OWNER:
Silo Ridge Ventures, LLC
 5021 Route 44
 Amenia, New York 12501
 845.373.8020

ARCHITECTS, PLANNERS, LANDSCAPE ARCHITECTS:
HART | HOWERTON
 10 East 40th Street New York, NY 10016
 Tel: 212.683.5631 Fax: 212.481.3768
 Email: NY@hart-howerton.com

GOLF COURSE DESIGNERS:
FAZIO DESIGN
 401 N. Main St., Ste. 400
 Hendersonville, North Carolina 28792
 828.693.0052 • FAX 828.693.0071

ENVIRONMENTAL PLANNING & CIVIL ENGINEERING:
VHB
Engineering, Surveying & Landscape Architecture, PC
 Planning
 Transportation
 Land Development
 Environmental Services
 50 Main Street, Suite 360
 White Plains, New York 10606
 914.467.6600 • FAX 914.761.3759

WASTEWATER AND WATER DESIGN:
CEDARWOOD ENGINEERING SERVICES, PLLC
 CIVIL & ENVIRONMENTAL ENGINEERING
 8-12 Dietz St., Suite 303
 Oneonta, NY 10747.413.8073
 248 Main St., PO Box 203
 North Creek, NY 518.251.5160

PROJECT SURVEYOR:
Kirk K. Horton, Land Surveyor
 NYS License No. 049954
 9 Broadway
 Amenia, New York 12501
 845.373.7809

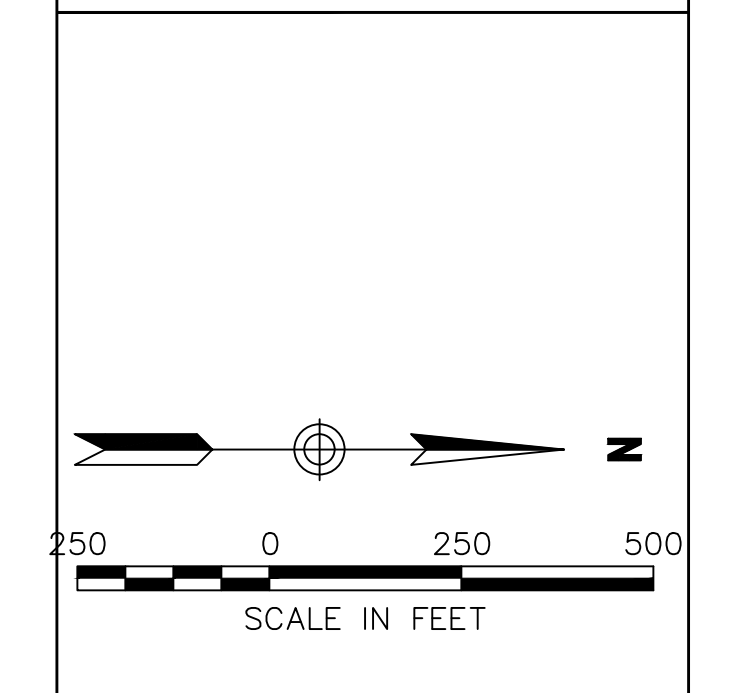
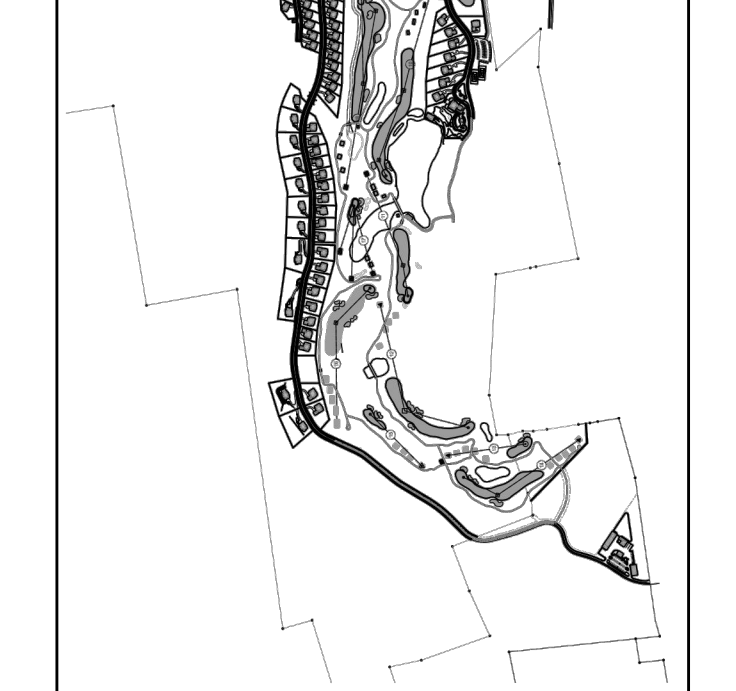

Rev.	Description	Date	By
2	PER TOWN COMMENTS	8/11/14	MB
1	PER TOWN COMMENTS	6/19/14	MB

Designed by **JC** Drawn by **CMG** Checked by **MWJ**
 CAD checked by **MB** Approved by **ACD**
 Date: As Shown Date: March 3, 2014
 Project Title:

Silo Ridge Resort Community
 4651 Route 22
 Amenia, New York
 Issued for:
Site Plan - Phase 1

Not Issued for Construction
 Overall Erosion and Sediment Control Plan
 Drawing Number:
C12.00
 Sheet of 118
 Project Number:
 29011.00

Match Line

See Sheet C12.02

See Sheet C12.09

See Sheet C12.03



OWNER:
 Silo Ridge Ventures, LLC
 5021 Route 44
 Amenia, New York 12501
 845.373.8020

ARCHITECTS, PLANNERS, LANDSCAPE ARCHITECTS:
HART | HOWERTON
 10 East 40th Street New York, NY 10016
 Tel: 212.683.5631 Fax: 212.481.3768
 E-mail: NY@hhowerton.com

GOLF COURSE DESIGNERS:
FAZIO DESIGN
 401 N. Main St., Ste. 400
 Hendersonville, North Carolina 28792
 828.693.0052 • FAX 828.693.0071

ENVIRONMENTAL PLANNING & CIVIL ENGINEERING:
VHB
Engineering, Surveying & Landscape Architecture, PC
 Planning
 Transportation
 Land Development
 Environmental Services
 50 Main Street, Suite 360
 White Plains, New York 10606
 914.467.6600 • FAX 914.761.3759

WASTEWATER AND WATER DESIGN:
CEDARWOOD ENGINEERING SERVICES, PLLC
 CIVIL & ENVIRONMENTAL ENGINEERING
 8-12 Dues St., Suite 303
 Oneonta, NY 14857
 248 Main St., PO Box 203
 North Creek, NY 13823
 518.251.5160

PROJECT SURVEYOR:
Kirk K. Horton, Land Surveyor
 NYS License No. 049954
 9 Broadway
 Amenia, New York 12501
 845.373.7809

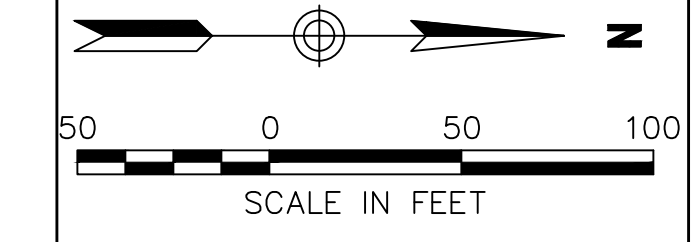
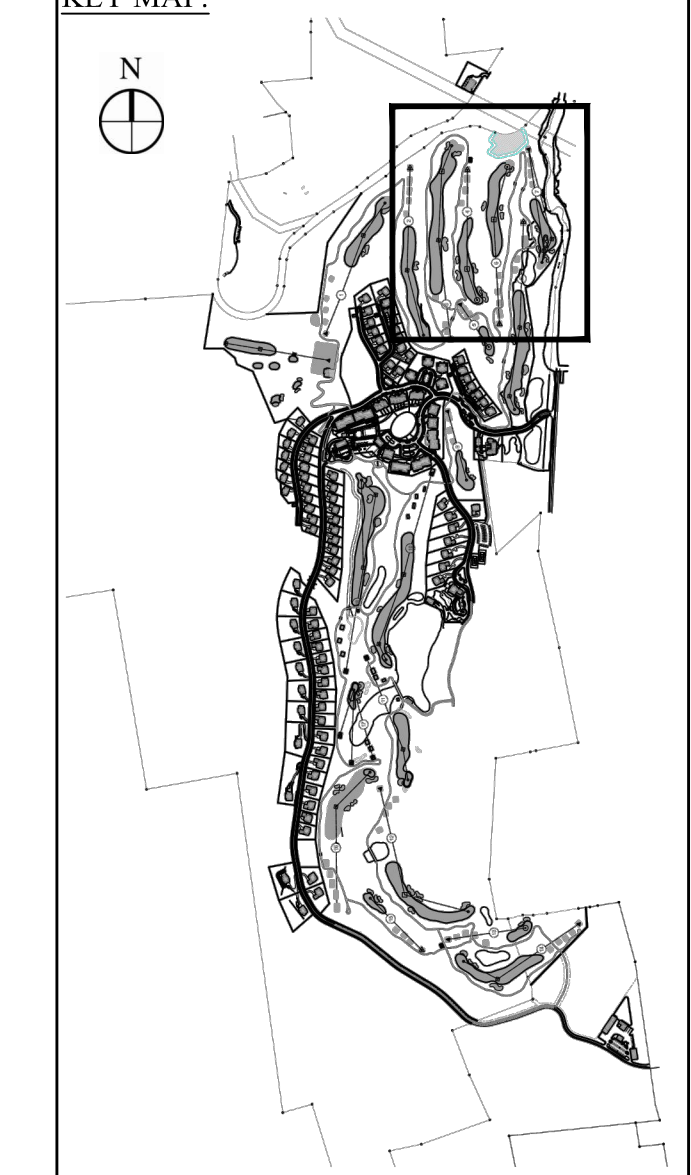

1	PER TOWN COMMENTS	6/19/14	AD

Silo Ridge Resort Community
 4651 Route 22
 Amenia, New York

Issued for:
Site Plan - Phase 1

Not Issued for Construction
 Drawing Title

Erosion and Sediment Control Plan 1

Drawing Number
C12.01
 Sheet 119 of 119
 Project Number
 29011.00

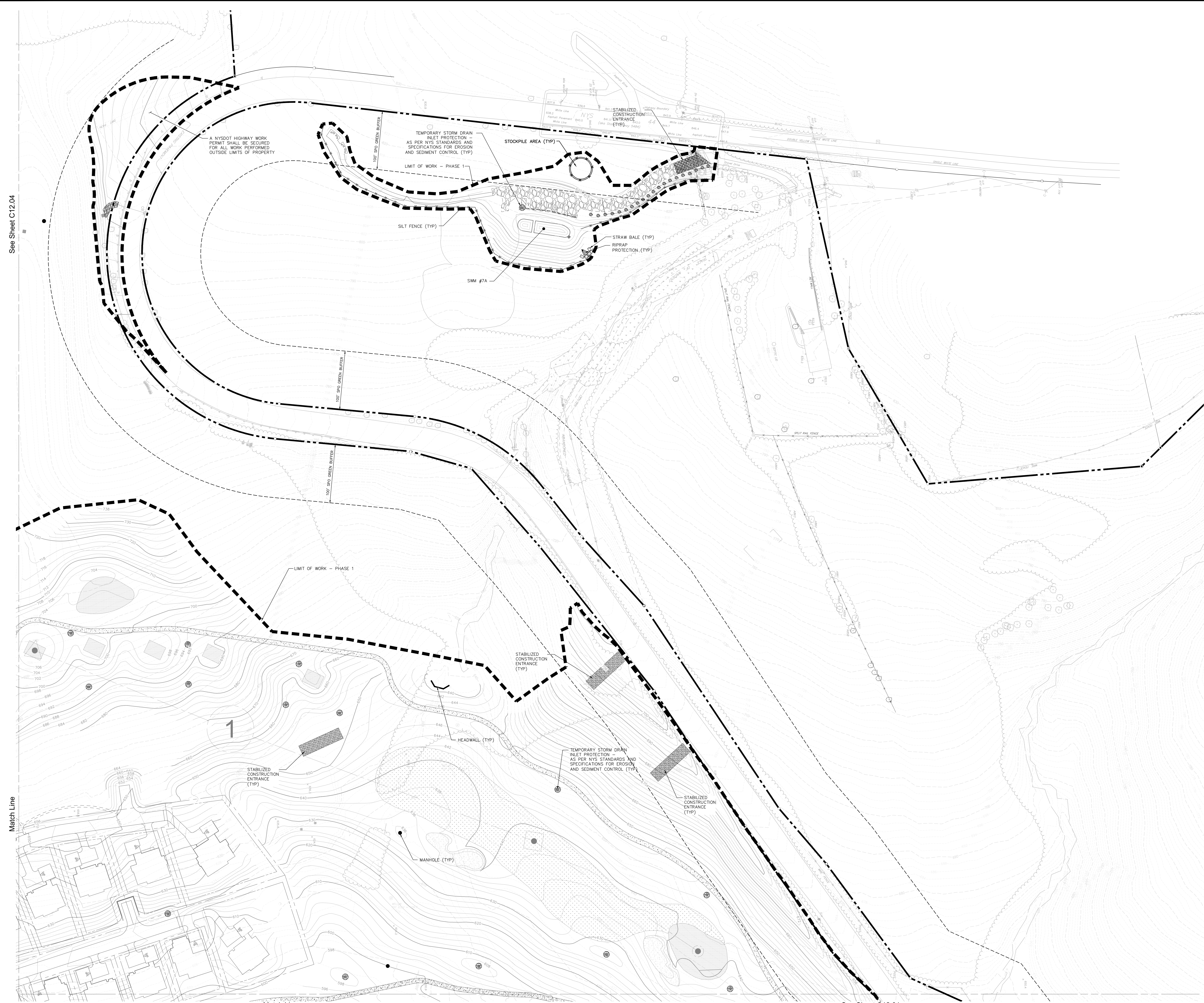

See Sheet C12.04

Match Line

Match Line

See Sheet C12.01

OWNER:
 Silo Ridge Ventures, LLC
 5021 Route 44
 Amenia, New York 12501
 845.373.8020

ARCHITECTS, PLANNERS, LANDSCAPE ARCHITECTS:
 HART | HOWERTON
 10 East 40th Street New York, NY 10016
 Tel: 212.683.5631 Fax: 212.481.3768
 Email: NY@hart-howerton.com

GOLF COURSE DESIGNERS:
FAZIO DESIGN
 401 N. Main St., Ste. 400
 Hendersonville, North Carolina 28792
 828.693.0052 • FAX 828.693.0071

ENVIRONMENTAL PLANNING & CIVIL ENGINEERING:
VHB
Engineering, Surveying & Landscape Architecture, PC
 Planning
 Transportation
 Land Development
 Environmental Services
 50 Main Street, Suite 360
 White Plains, New York 10606
 914.467.6600 • FAX 914.761.3759

WASTEWATER AND WATER DESIGN:
CEDARWOOD ENGINEERING SERVICES, PLLC
 CIVIL & ENVIRONMENTAL ENGINEERING
 8-12 Dietz St., Suite 303
 Oneonta, NY 14857-4232-3073
 248 Main St., PO Box 203
 North Creek, NY 518.251.5160

PROJECT SURVEYOR:
Kirk K. Horton, Land Surveyor
 NYS License No. 049954
 9 Broadway
 Amenia, New York 12501
 845.373.7809

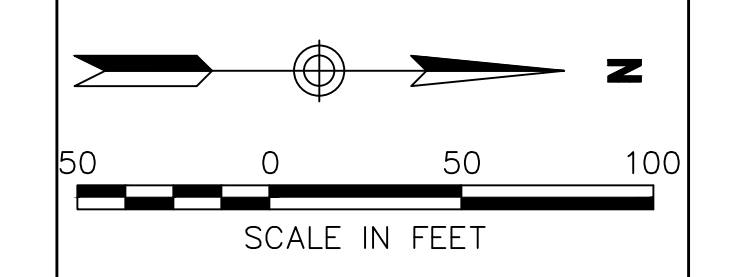
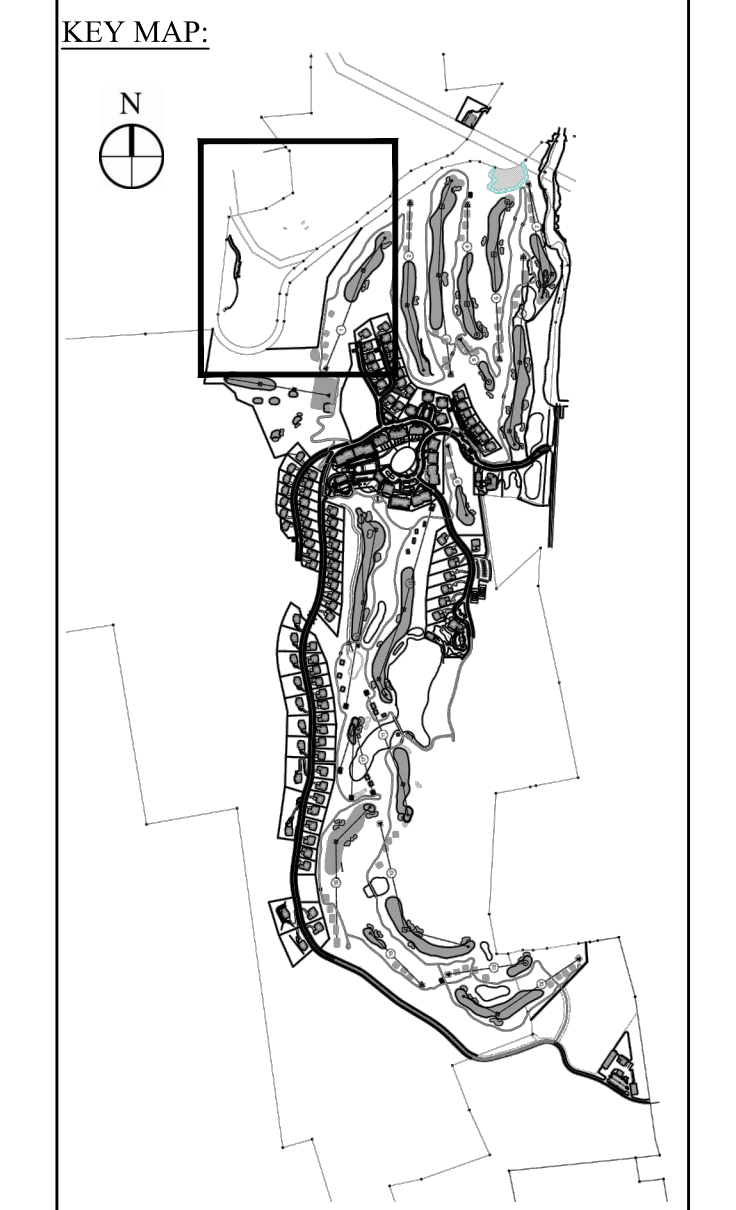

1	PER TOWN COMMENTS	6/19/14	ACD

Silo Ridge Resort Community
 4651 Route 22
 Amenia, New York
 Project Title
Site Plan - Phase 1

Not Issued for Construction
 Project Title

Erosion and Sediment Control Plan 2

Sheet Number
C12.02
 Sheet of
 120
 Project Number
 29011.00



See Sheet C12.05

See Sheet C12.01

Match Line

Match Line

OWNER:
Silo Ridge Ventures, LLC
5021 Route 44
Amenia, New York 12501
845.373.8020

ARCHITECTS, PLANNERS, LANDSCAPE ARCHITECTS:
HART | HOWERTON
10 East 40th Street New York, NY 10016
Tel: 212.683.5631 Fax: 212.481.3768
Email: NY@hart-howerton.com

GOLF COURSE DESIGNERS:
FAZIO DESIGN
401 N. Main St., Ste. 400
Hendersonville, North Carolina 28792
828.693.0052 • FAX 828.693.0071

ENVIRONMENTAL PLANNING & CIVIL ENGINEERING:
VHB
Engineering, Surveying & Landscape Architecture, PC
Planning
Transportation
Land Development
Environmental Services
50 Main Street, Suite 360
White Plains, New York 10606
914.467.6600 • FAX 914.761.3759

WASTEWATER AND WATER DESIGN:
CEDARWOOD ENGINEERING SERVICES, PLLC
CIVIL & ENVIRONMENTAL ENGINEERING
8-12 Dietz St., Suite 303
Oneonta, NY 14857-4323-8073
248 Main St., PO Box 203
North Creek, NY 518.251.5160

PROJECT SURVEYOR:
Kirk K. Horton, Land Surveyor
NYS License No. 049954
9 Broadway
Amenia, New York 12501
845.373.7809

KEY MAP:
N
[Key Map Diagram]
50 0 50 100
SCALE IN FEET

1	PER TOWN COMMENTS	6/19/14	ACD
Revised	Revision	Date	Prepared

Designed by **JC** Drawn by **CMG** Checked by **MWJ**
 CAD checked by **MB** Approved by **ACD**
 Date: As Shown Date: March 3, 2014
 Project Title: **Silo Ridge Resort Community**
 4651 Route 22
 Amenia, New York
 Issued for: **Site Plan - Phase 1**
 Not Issued for Construction
 Erosion and Sediment Control Plan 3

Sheet Number: **C12.03**
 Sheet 121 of 121
 Project Number: 29011.00

29011.00-PI_1R.DWG

A NYS DOT HIGHWAY WORK PERMIT SHALL BE SECURED FOR ALL WORK PERFORMED OUTSIDE LIMITS OF PROPERTY



OWNER:
 Silo Ridge Ventures, LLC
 5021 Route 44
 Amenia, New York 12501
 845.373.8020

ARCHITECTS, PLANNERS, LANDSCAPE ARCHITECTS:
HART | HOWERTON
 10 East 40th Street New York, NY 10016
 Tel: 212.683.5631 Fax: 212.481.3768
 Email: NY@hart-howerton.com

GOLF COURSE DESIGNERS:
FAZIO DESIGN
 401 N. Main St., Ste. 400
 Hendersonville, North Carolina 28792
 828.693.0052 • FAX 828.693.0071

ENVIRONMENTAL PLANNING & CIVIL ENGINEERING:
VHB
Engineering, Surveying & Landscape Architecture, PC
 Planning
 Transportation
 Land Development
 Environmental Services
 50 Main Street, Suite 360
 White Plains, New York 10606
 914.467.6600 • FAX 914.761.3759

WASTEWATER AND WATER DESIGN:
CEDARWOOD ENGINEERING SERVICES, PLLC
 CIVIL & ENVIRONMENTAL ENGINEERING
 8-12 Dietz St., Suite 303
 Oneonta, NY 14857-4123-3073
 248 Main St., PO Box 203
 North Creek, NY 518.251.5160

PROJECT SURVEYOR:
Kirk K. Horton, Land Surveyor
 NYS License No. 049954
 9 Broadway
 Amenia, New York 12501
 845.373.7809

KEY MAP:

SCALE IN FEET
 0 50 100

1	PER TOWN COMMENTS	6/19/14	ACD
	Revision	Date	Prepared
Designed by	JC	Drawn by	CMG
CAD checked by	MB	Approved by	ACD
Check	As Shown	Date	March 3, 2014
Project Title	Silo Ridge Resort Community		
Address	4651 Route 22 Amenia, New York		
Issued for	Site Plan - Phase 1		
Not Issued for Construction	Project Title		
Project Title	Erosion and Sediment Control Plan 5		
Sheet Number	C12.05		
Sheet of	123 of		
Project Number	29011.00		

Drawing Number
C12.05
Sheet of
123 of
Project Number
29011.00

Sheet Friday, June 27, 2014 2:34:27 PM CORPENG Plotted Friday, June 27, 2014 3:21:17 PM Cheung, Jason



See Sheet C12.08

See Sheet C12.04

Match Line

Match Line

Match Line

See Sheet C12.05

OWNER:
 Silo Ridge Ventures, LLC
 5021 Route 44
 Arden, New York 12501
 845.373.8020

ARCHITECTS, PLANNERS, LANDSCAPE ARCHITECTS:
HART | HOWERTON
 10 East 40th Street New York, NY 10016
 Tel: 212.683.5631 Fax: 212.481.3768
 Email: NY@hart-howerton.com

GOLF COURSE DESIGNERS:
FAZIO DESIGN
 401 N. Main St., Ste. 400
 Hendersonville, North Carolina 28792
 828.693.0052 • FAX 828.693.0071

ENVIRONMENTAL PLANNING & CIVIL ENGINEERING:
VHB
Engineering, Surveying & Landscape Architecture, PC
 Planning
 Transportation
 Land Development
 Environmental Services
 50 Main Street, Suite 360
 White Plains, New York 10606
 914.467.6600 • FAX 914.761.3759

WASTEWATER AND WATER DESIGN:
CEDARWOOD ENGINEERING SERVICES, PLLC
 CIVIL & ENVIRONMENTAL ENGINEERING
 8-12 Dues St., Suite 303
 Oneonta, NY 14857-4230/3073
 248 Main St., PO Box 203
 North Creek, NY 518.251.5160

PROJECT SURVEYOR:
Kirk K. Horton, Land Surveyor
 NYS License No. 049954
 9 Broadway
 Arden, New York 12501
 845.373.7809

KEY MAP:

SCALE IN FEET
 0 50 100

1	PER TOWN COMMENTS	6/19/14	ACD
	Revision	Date	Prepared
Designed by	JC	Drawn by	CMG
CAD checked by	MB	Approved by	ACD
Date	As Shown	Date	March 3, 2014

Silo Ridge Resort Community
 4651 Route 22
 Arden, New York
 Issued for
Site Plan - Phase 1

Not Issued for Construction
 Priority Title

Erosion and Sediment Control Plan 6

Drawing Number
C12.06
 Sheet 124 of
 Project Number
 29011.00

29011.00-PI-ER.DWG

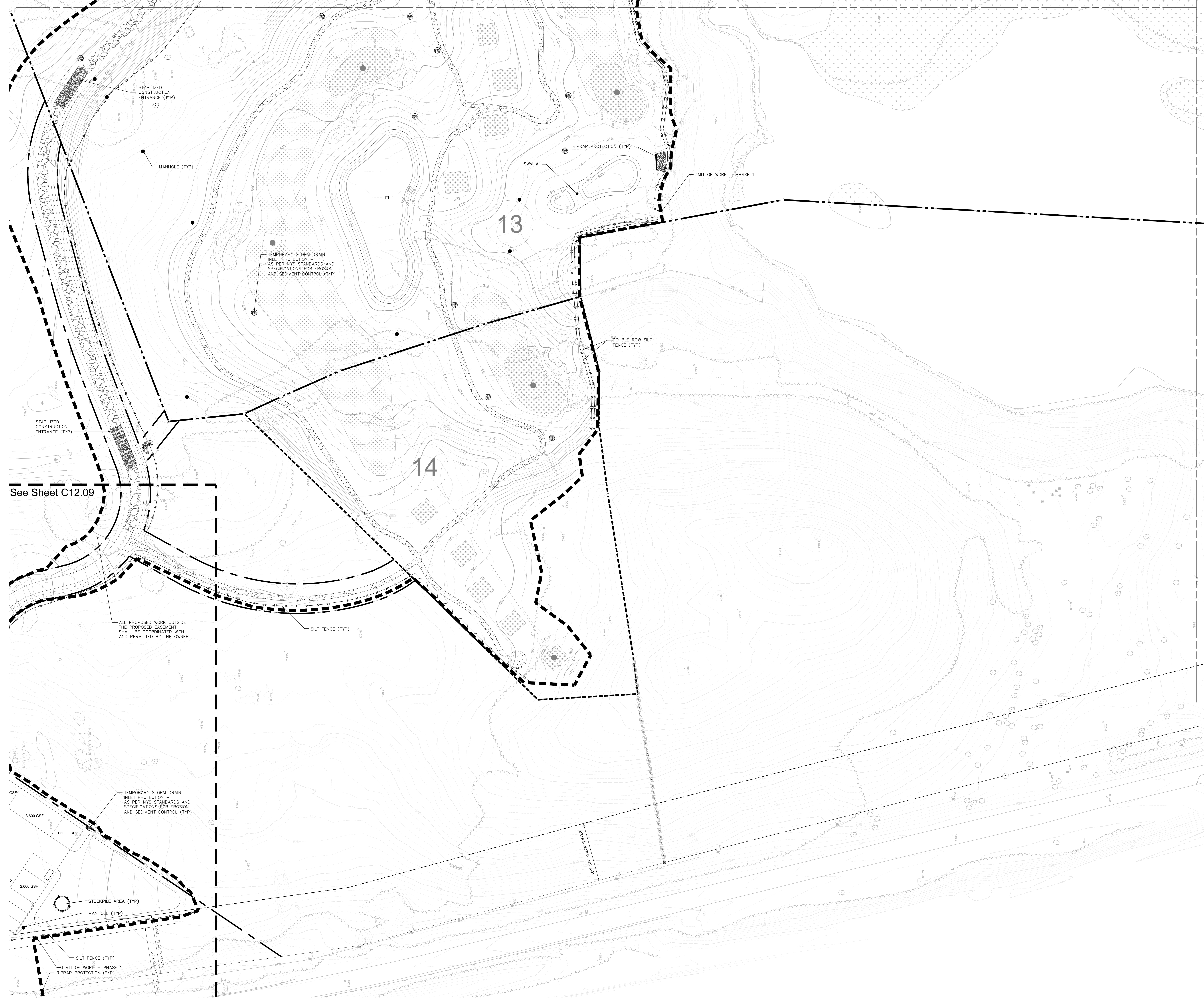

See Sheet C12.09

See Sheet C12.05

OWNER:
Silo Ridge Ventures, LLC
 5021 Route 44
 Arden, New York 12501
 845.373.8020

ARCHITECTS, PLANNERS, LANDSCAPE ARCHITECTS:
HART | HOWERTON
 10 East 40th Street New York, NY 10016
 Tel: 212.683.5631 Fax: 212.481.3768
 E-mail: NY@hart-howerton.com

GOLF COURSE DESIGNERS:
FAZIO DESIGN
 401 N. Main St., Ste. 400
 Hendersonville, North Carolina 28792
 828.693.0052 • FAX 828.693.0071

ENVIRONMENTAL PLANNING & CIVIL ENGINEERING:
VHB
Engineering, Surveying & Landscape Architecture, PC
 Planning
 Transportation
 Land Development
 Environmental Services
 50 Main Street, Suite 360
 White Plains, New York 10606
 914.467.6600 • FAX 914.761.3759

WASTEWATER AND WATER DESIGN:
CEDARWOOD ENGINEERING SERVICES, PLLC
 CIVIL & ENVIRONMENTAL ENGINEERING
 8-12 Dietz St., Suite 303
 Oneonta, NY 14857
 248 Main St., PO Box 203
 North Creek, NY 518.251.5160

PROJECT SURVEYOR:
Kirk K. Horton, Land Surveyor
 NYS License No. 049954
 9 Broadway
 Arden, New York 12501
 845.373.7809

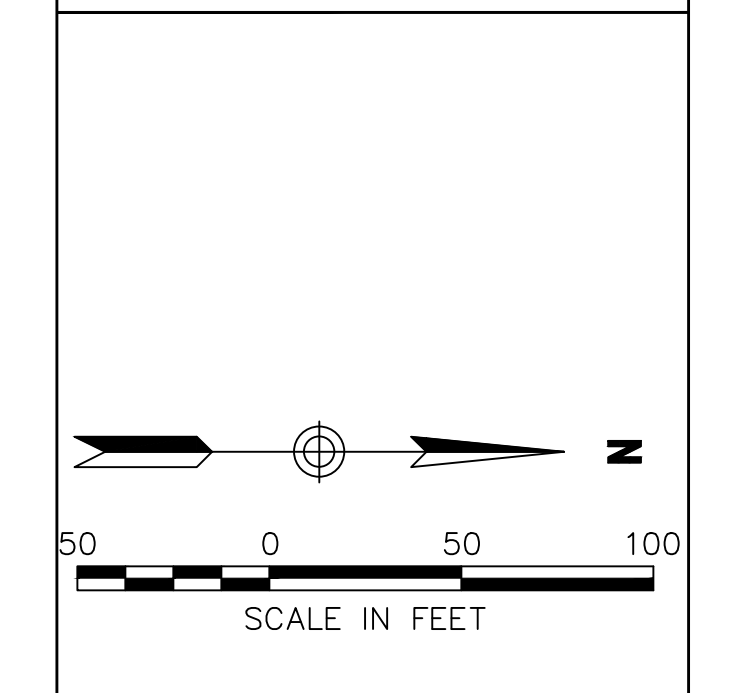
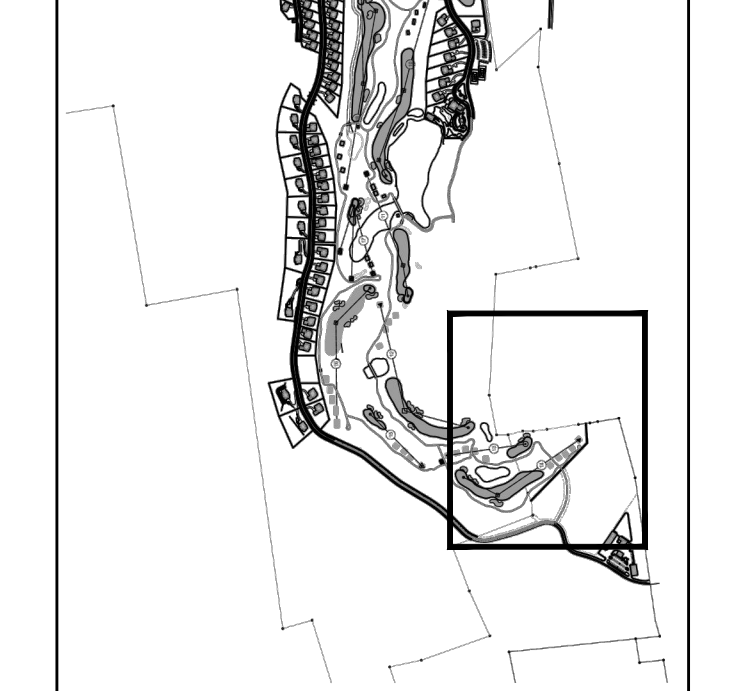

1	PER TOWN COMMENTS	6/19/14	ACD
Revised	Revision	Date	By
Designed by	Drawn by	Checked by	Reviewed by
CAD checked by	MB	Approved by	ACD
Date	As Shown	Date	March 3, 2014

Silo Ridge Resort Community
 4651 Route 22
 Arden, New York

Issued for:
Site Plan - Phase 1

Not Issued for Construction
 Erosion and Sediment Control Plan 7

Sheet Number
C12.07
 125 of
 Project Number
 29011.00

