

Lighting Plan Notes:

- ALL LIGHTING PHOTOMETRICS SHOWN IS APPROXIMATE AND WERE TAKEN FROM LIGHTING MANUFACTURERS SPECIFICATION SHEETS.
- THE PHOTOMETRICS SHOWN ON THE PLANS ARE FOR BOLLARD, PATH, AND BUILDING LIGHTS ONLY. ADDITIONAL UPLIGHTING SOURCES SHOWN IN POOL AREAS AND UNDER TREES ARE SHOWN FOR LOCATION PURPOSES ONLY. SEE SHEET SL1.06 FOR ADDITIONAL INFORMATION.
- UPLIGHTING SHALL BE SHIELDED TO CONFORM TO THE DARK SKY STANDARDS.
- PHOTOMETRIC AREAS WITH NO CALCULATION NUMBERS SHOWN ARE 0.0 CALCULATION POINTS.

| OVERALL LIGHT TOTALS | |
|---|----------|
| TYPE | QUANTITY |
| Beachside Lighting R7 Pathlight | 873 |
| Beachside Lighting MB3 Bollard Light | 227 |
| Hubbardton Forge Banded Large Sconce w/ Top Plate | 120 |
| Teka Illumination Beacon Wall Mount | * 45 |
| Hubbardton Forge Double Banded Outdoor Chain-Hung Ceiling Fixture | 1 |
| BK-Lighting MR-11 Halogen Landscape Lighting Fixture w/ shield | * 128 |
| BK-Lighting 6" Square Gold Star | * 19 |

* ESTIMATED

SHEET SL1.05 - VIEW I

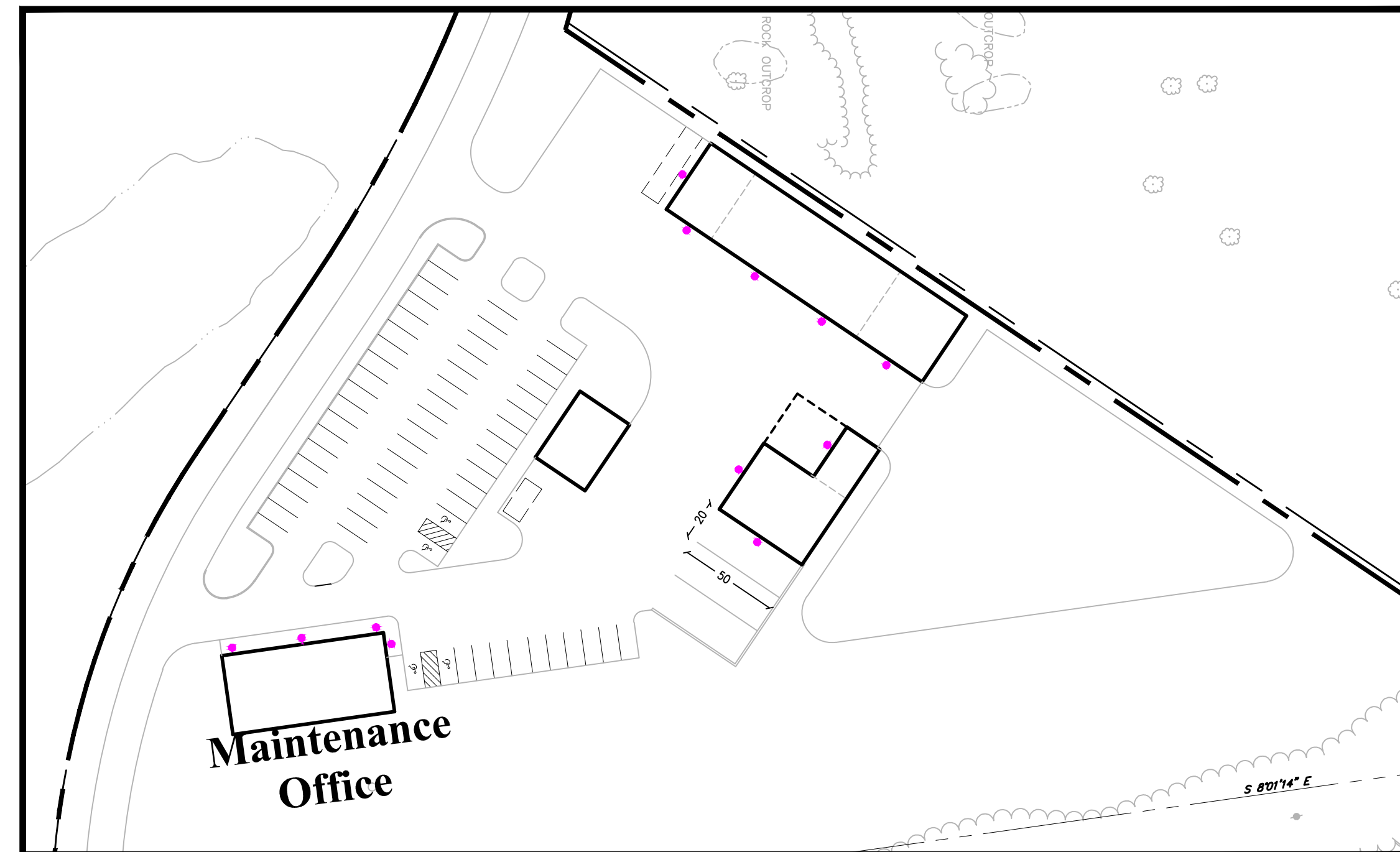

SHEET SL1.05 - VIEW J

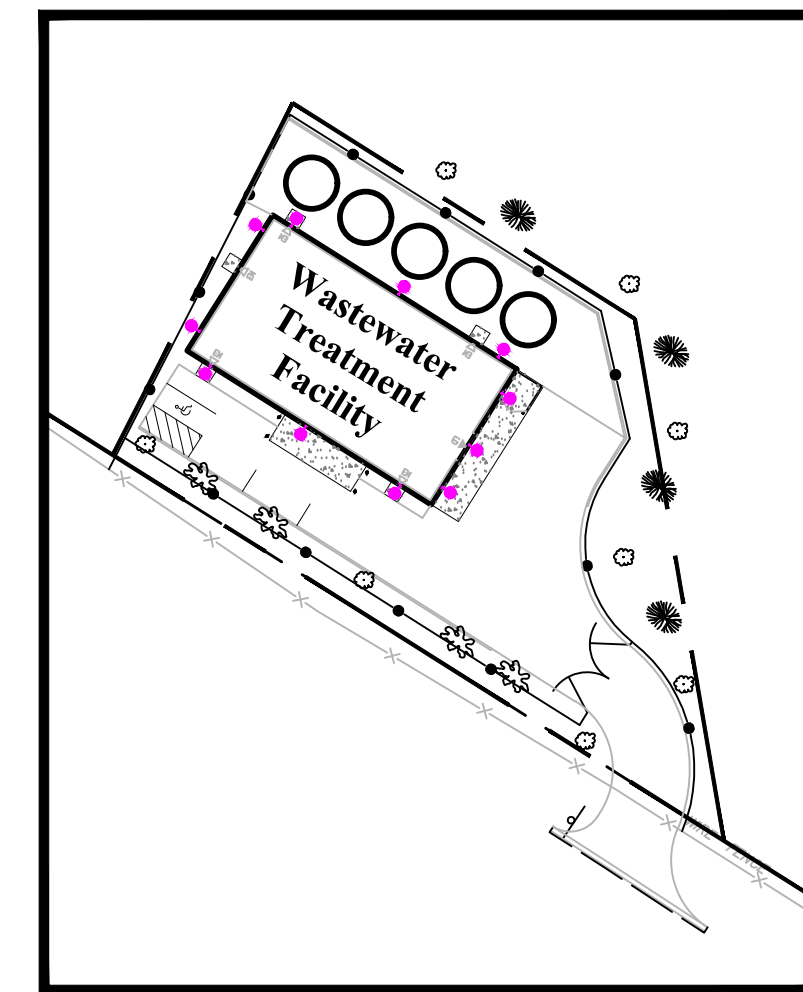

SHEET SL1.01 - VIEW A

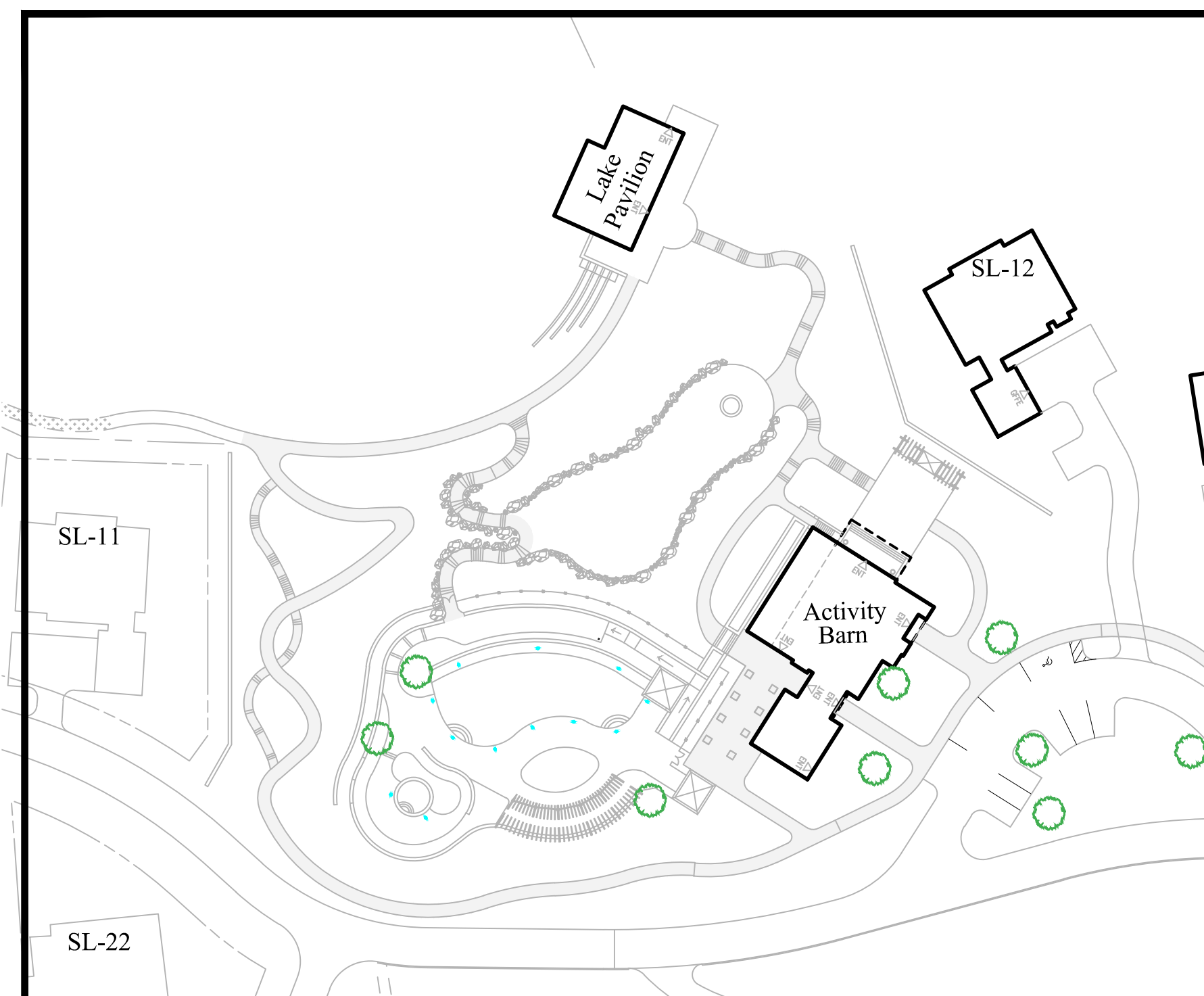

SHEET SL1.01 - VIEW B

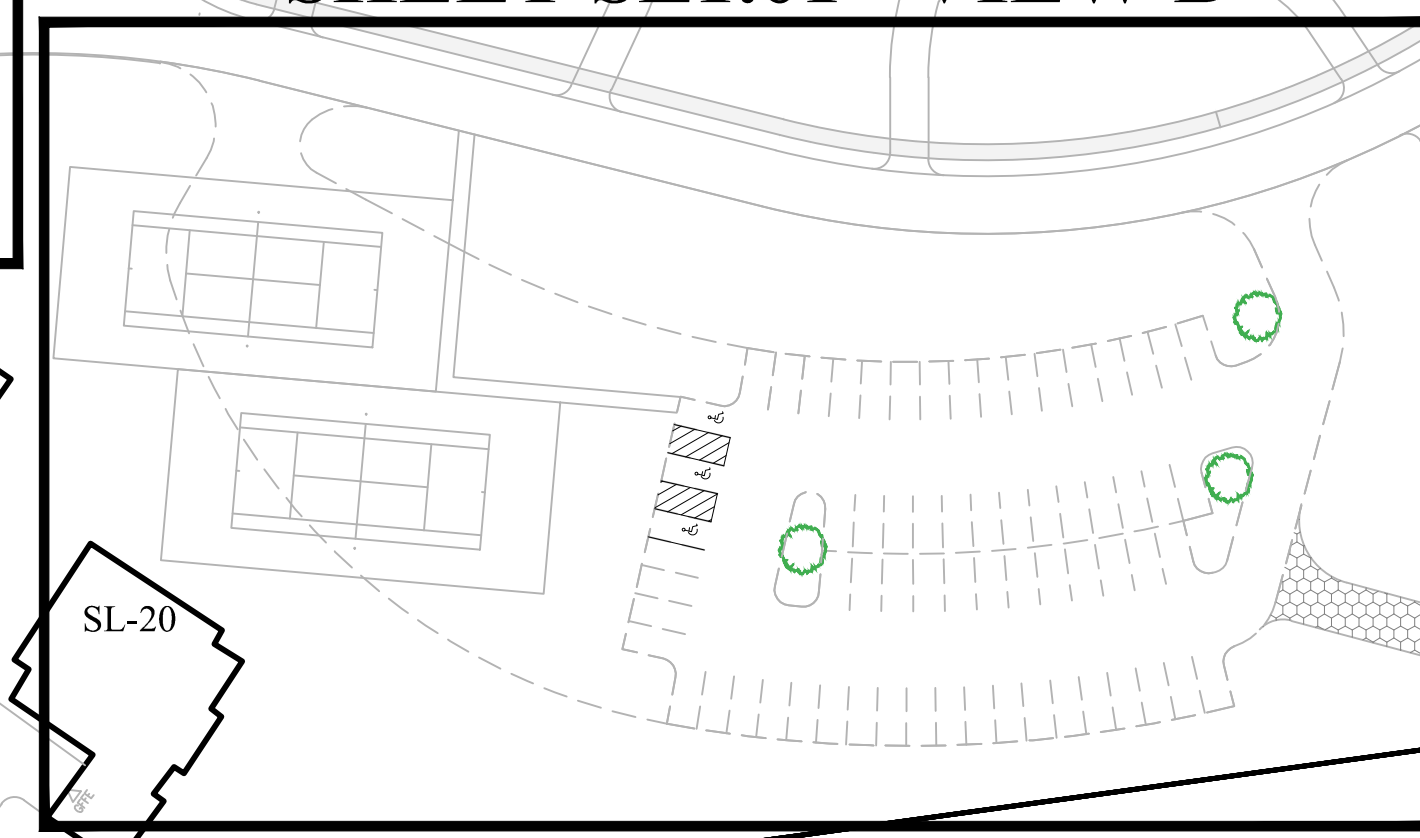

**SHEET SL1.03
VIEW E**

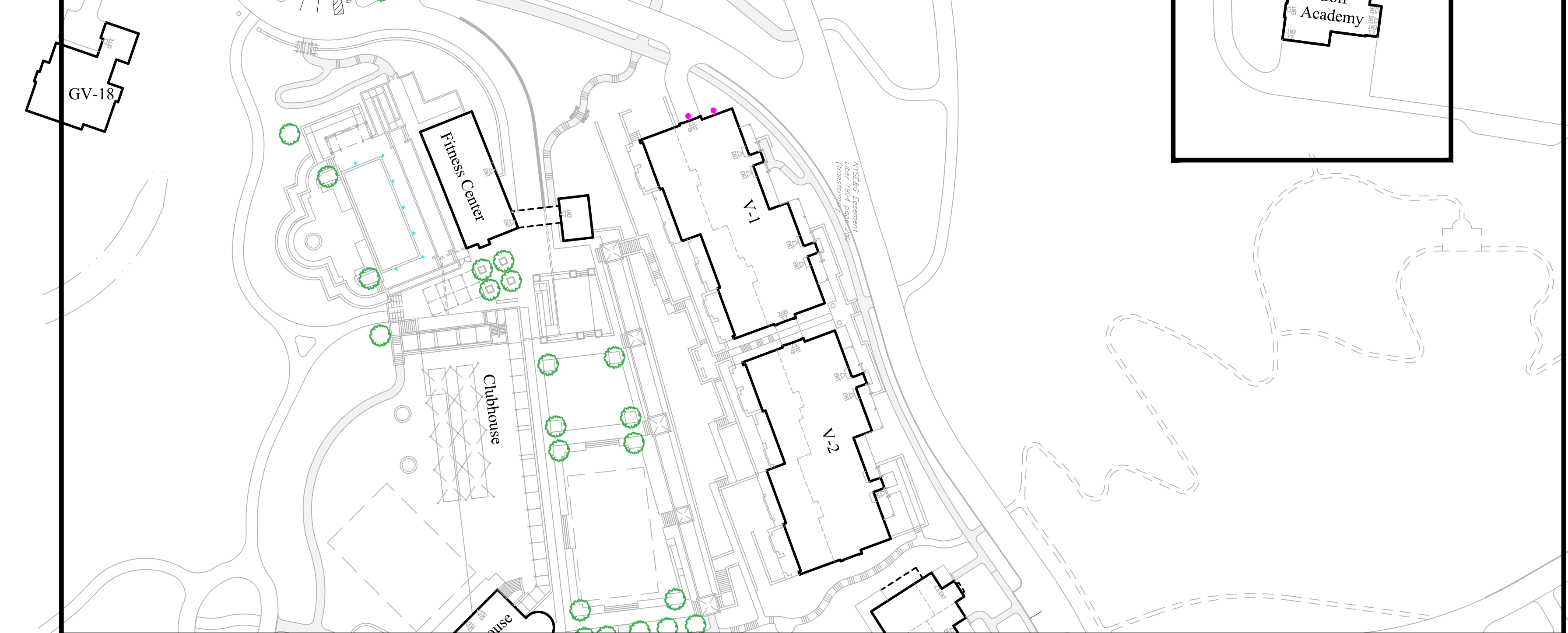

SHEET SL1.03 - VIEW G

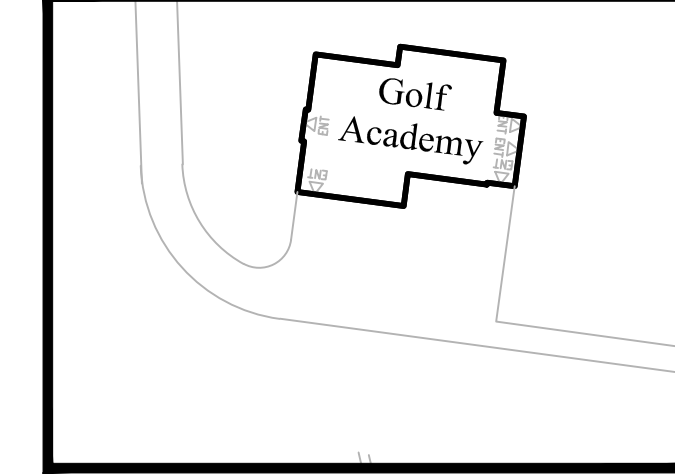

**SHEET SL1.02
VIEW E**

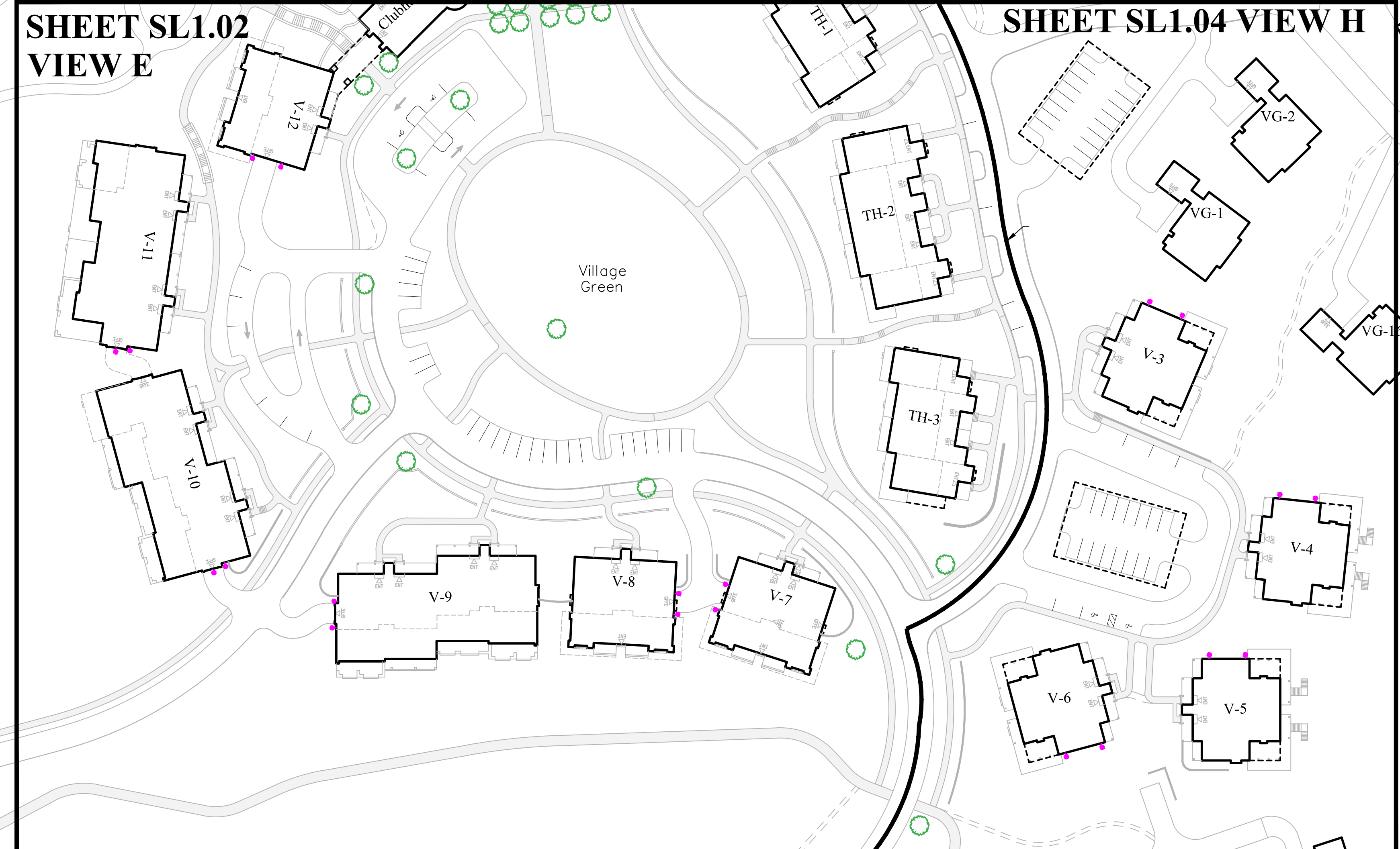

SHEET SL1.04 VIEW H

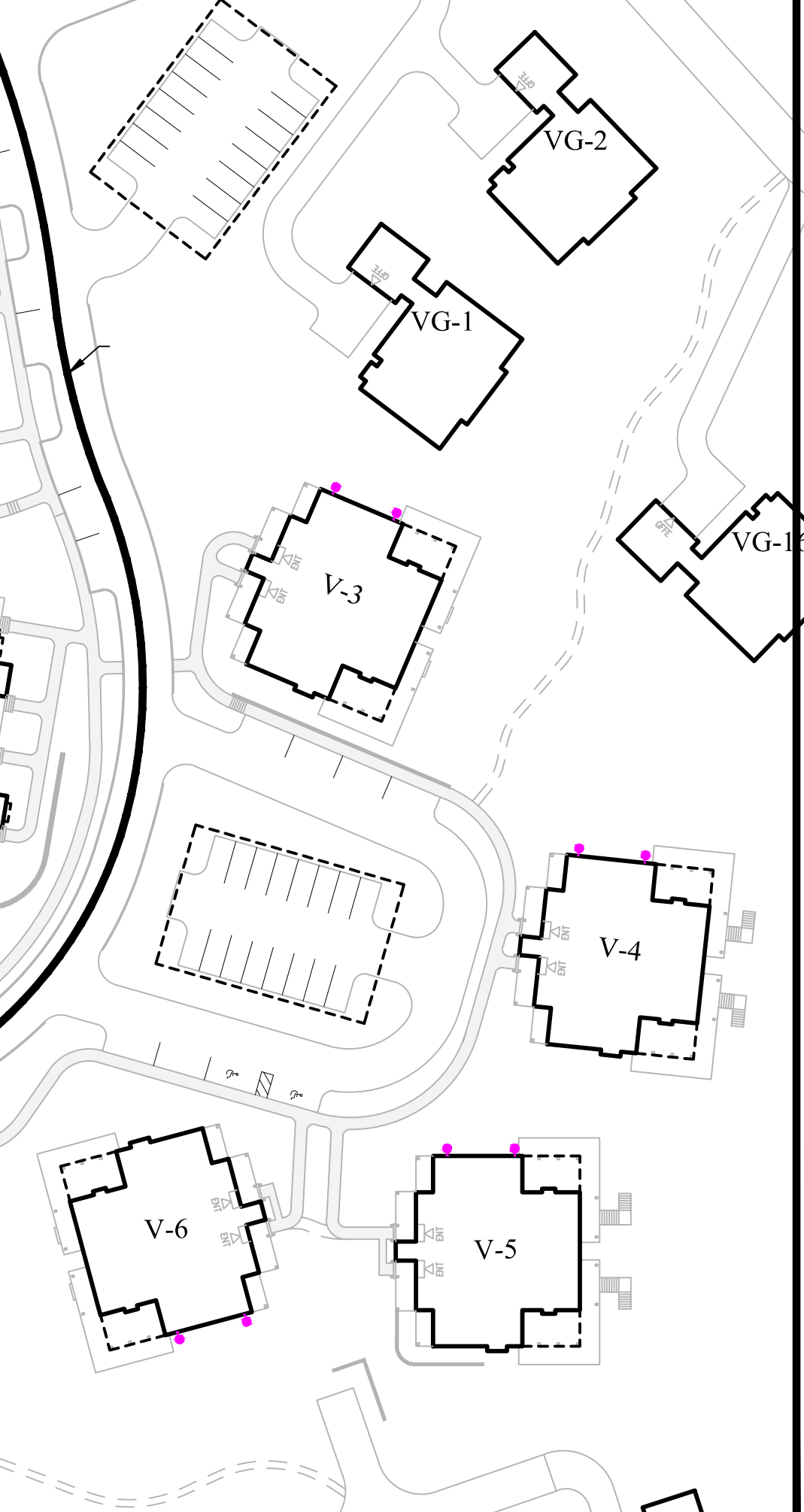

SHEET SL1.01 - VIEW D



SHEET SL1.01 - VIEW C

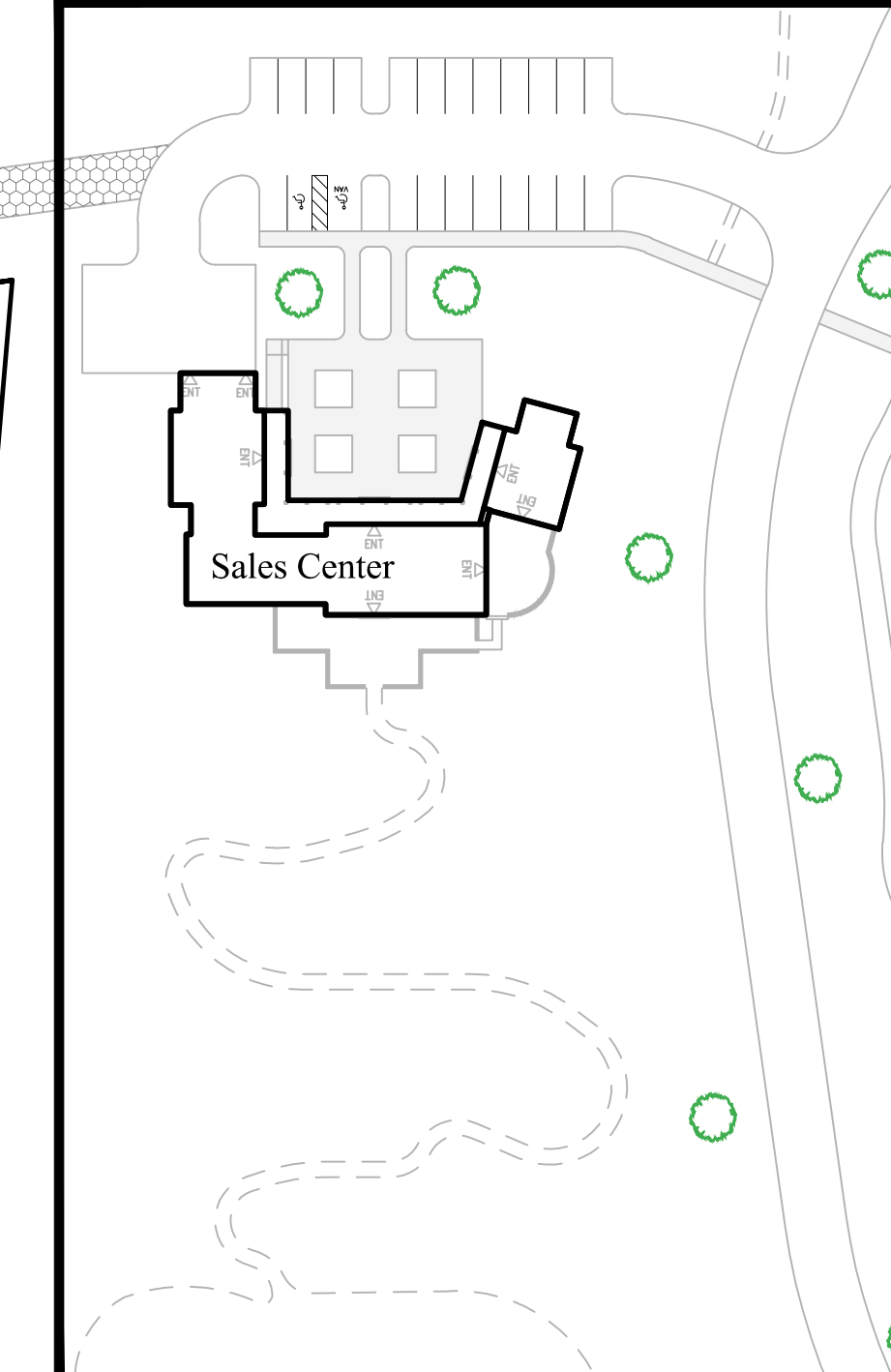

SHEET SL1.01 - VIEW D

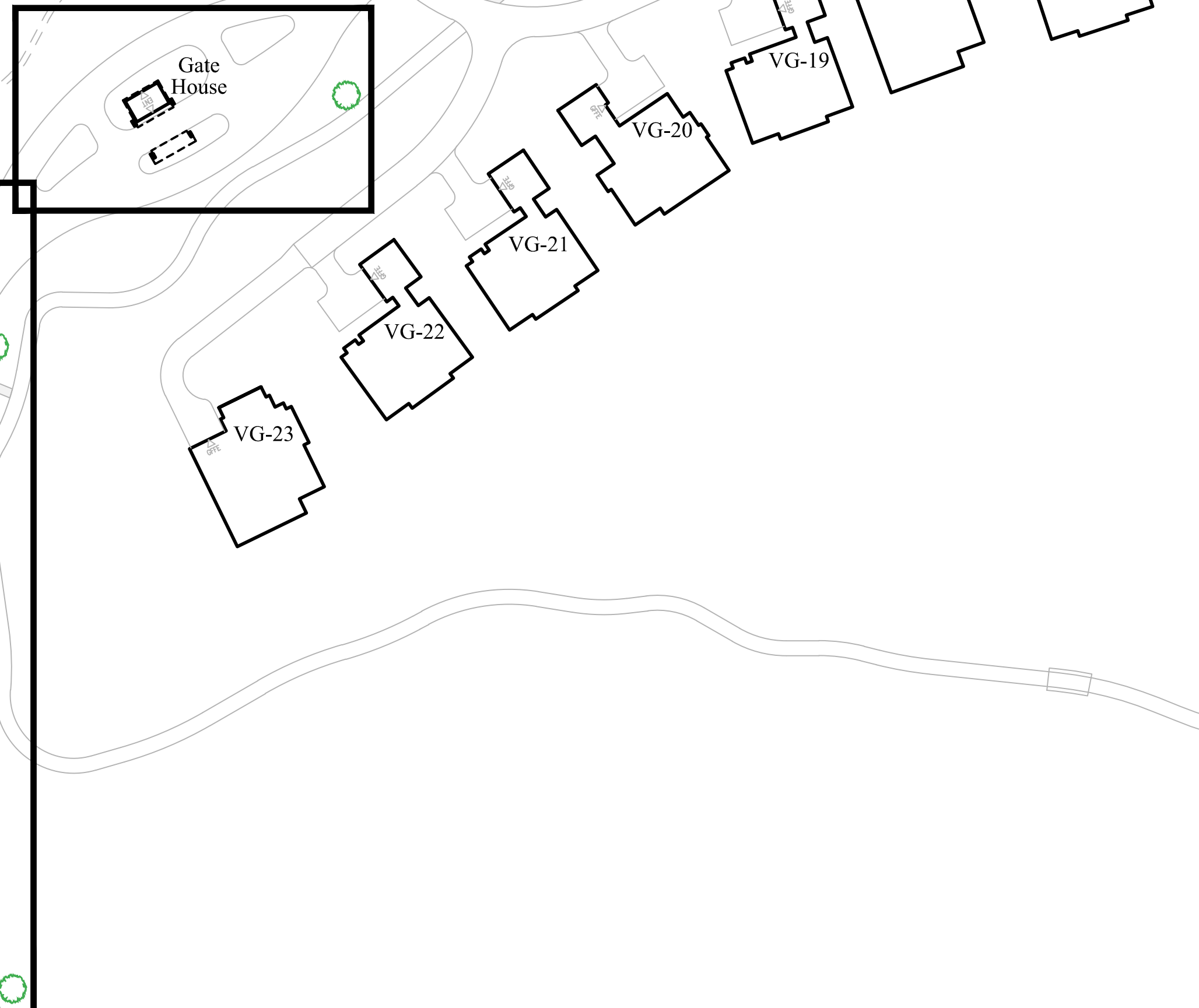

OWNER:
 Silo Ridge Ventures, LLC
 5021 Route 44
 Amenia, New York 12501
 845.373.8020

ARCHITECTS, PLANNERS, LANDSCAPE ARCHITECTS:
 HART | HOWERTON
 19 East 40th Street New York, NY 10016
 Tel: 212.683.5631 Fax: 212.481.3768
 Email: NY@hart-howerton.com

GOLF COURSE DESIGNERS:
FAZIO DESIGN
 401 N. Main St., Ste. 400
 Hendersonville, North Carolina 28792
 828.693.0052 • FAX 828.693.0071

ENVIRONMENTAL PLANNING & CIVIL ENGINEERING:
VHB
Engineering, Surveying & Landscape Architecture, PC
 Planning
 Transportation
 Land Development
 Environmental Services
 50 Main Street, Suite 360
 White Plains, New York 10606
 914.467.6600 • FAX 914.761.3759

WASTEWATER AND WATER DESIGN:
CEDARWOOD ENGINEERING SERVICES, PLLC
 CIVIL & ENVIRONMENTAL ENGINEERING
 8-12 Dietz St., Suite 303
 Oneonta, NY 14753-8073
 248 Main St., PO Box 203
 North Creek, NY 51825-5160

PROJECT SURVEYOR:
 Kirk K. Horton, Land Surveyor
 NYS License No. 049954
 9 Broadway
 Amenia, New York 12501
 845.373.7809

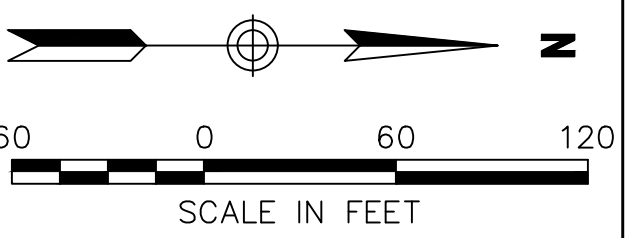
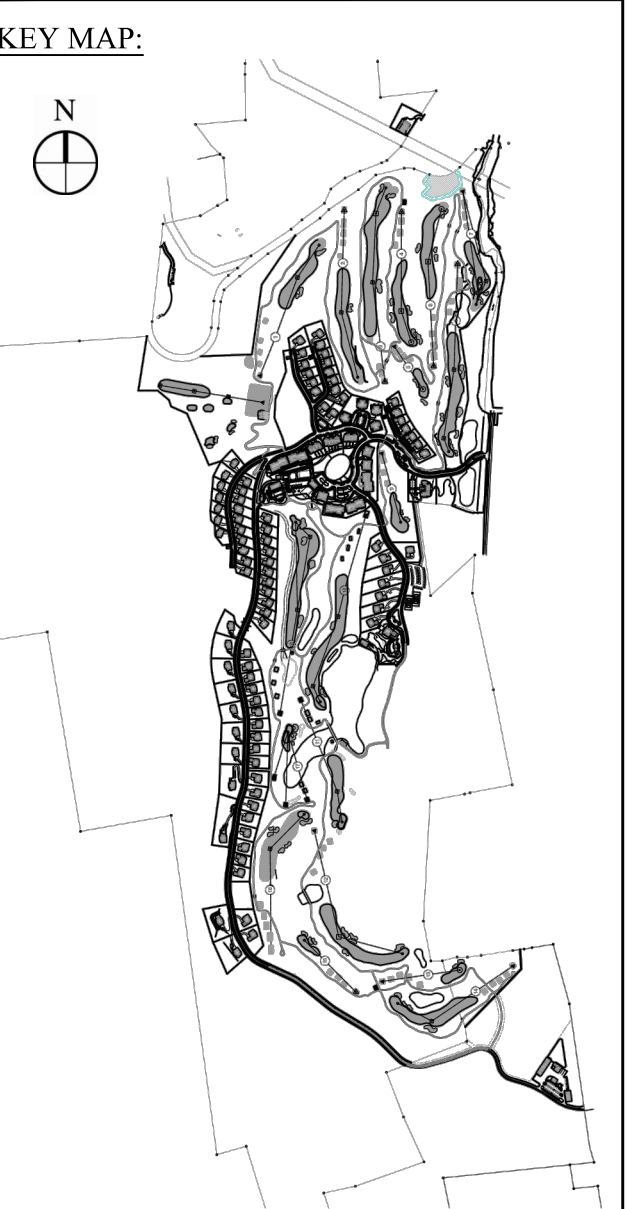

| No. | Revision | Date | By |
|-----|----------|------|----|
| | | | |
| | | | |
| | | | |
| | | | |

Prepared by CS Drawn by CS Checked by ACD
 CAD checked by CS Approved by ACD
 Scale 1" = 60' Date May 23, 2014

Project Title:
 Silo Ridge
 Resort Community
 4651 Route 22
 Amenia, New York

Issued for:
 Site Plan - Phase I

Not Issued for Construction
 Drawing Title
 Overall Lighting
 Key Plan / Notes

Drawing Number
SL1.00
 Sheet of
 Project Number
 29011.00



| VIEW A | |
|--|----------|
| TYPE | QUANTITY |
| Beachside Lighting R7 Pathlight | 194 |
| Beachside Lighting MB3 Bollard Light | 13 |
| Hubbardton Forge Banded Large Sconce w/ Top Plate | 12 |
| Teka Illumination Beacon Wall Mount | 0 |
| BK-Lighting MR-11 Halogen Landscape Lighting Fixture w/ shield | * 20 |
| BK-Lighting 6" Square Gold Star | * 12 |

| ACTIVITY BARN CALC. POINTS | | |
|----------------------------|---------|---------|
| Average | Maximum | Minimum |
| 1.42 | 10.2 | 0.1 |

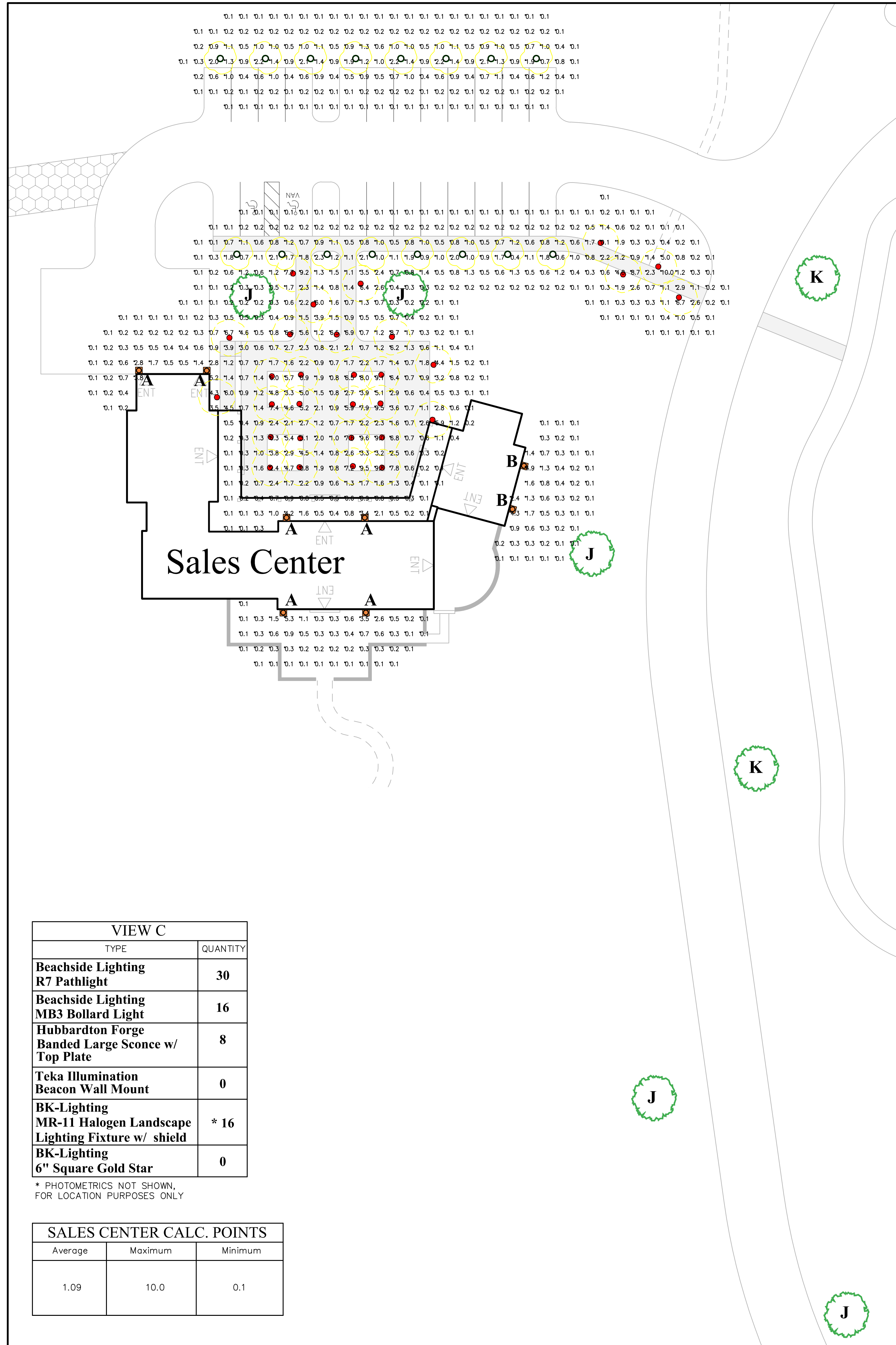

| VIEW C | |
|--|----------|
| TYPE | QUANTITY |
| Beachside Lighting R7 Pathlight | 30 |
| Beachside Lighting MB3 Bollard Light | 16 |
| Hubbardton Forge Banded Large Sconce w/ Top Plate | 8 |
| Teka Illumination Beacon Wall Mount | 0 |
| BK-Lighting MR-11 Halogen Landscape Lighting Fixture w/ shield | * 16 |
| BK-Lighting 6" Square Gold Star | 0 |

| SALES CENTER CALC. POINTS | | |
|---------------------------|---------|---------|
| Average | Maximum | Minimum |
| 1.09 | 10.0 | 0.1 |

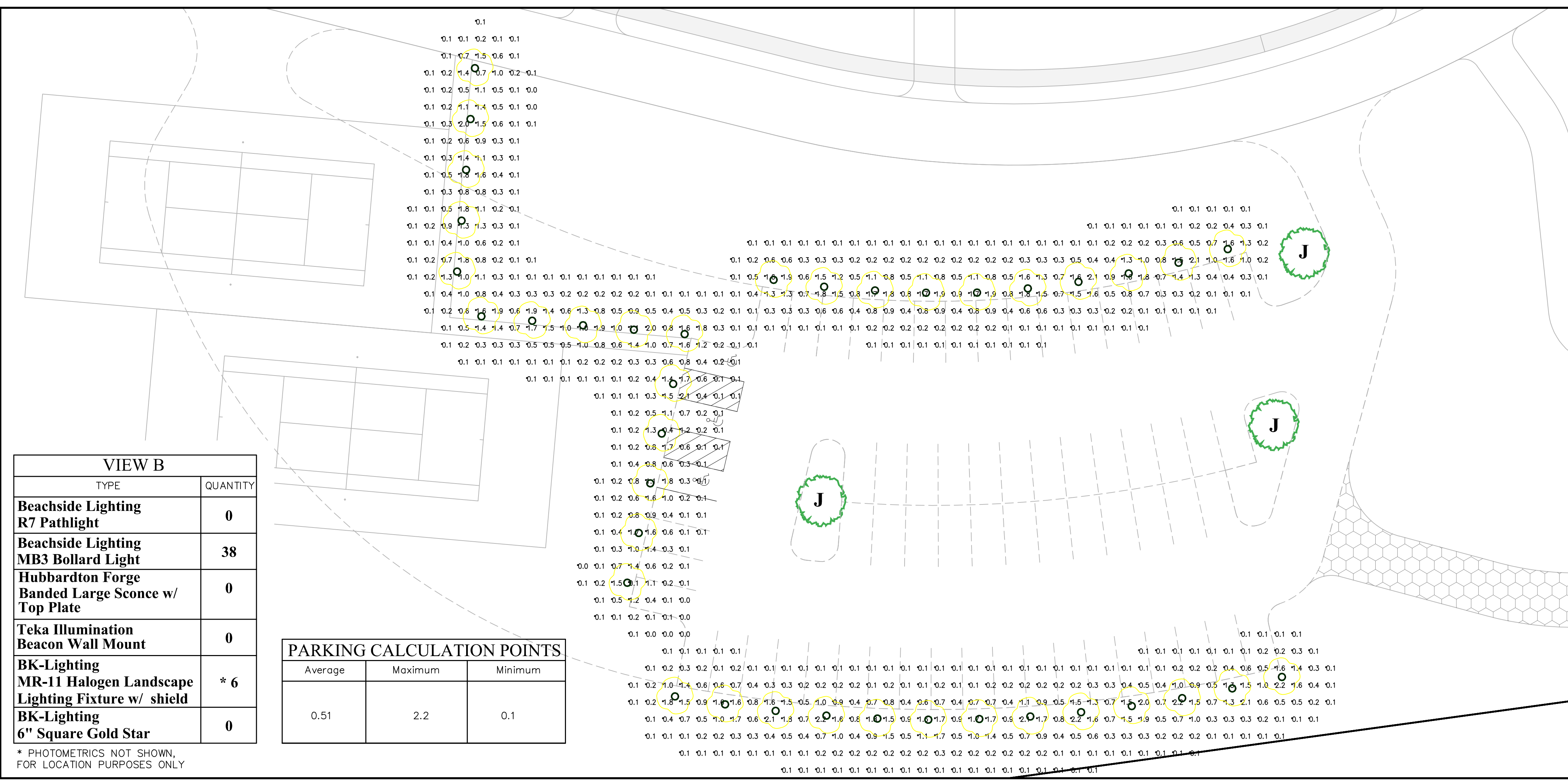

| VIEW B | |
|--|----------|
| TYPE | QUANTITY |
| Beachside Lighting R7 Pathlight | 0 |
| Beachside Lighting MB3 Bollard Light | 38 |
| Hubbardton Forge Banded Large Sconce w/ Top Plate | 0 |
| Teka Illumination Beacon Wall Mount | 0 |
| BK-Lighting MR-11 Halogen Landscape Lighting Fixture w/ shield | * 6 |
| BK-Lighting 6" Square Gold Star | 0 |

| PARKING CALCULATION POINTS | | |
|----------------------------|---------|---------|
| Average | Maximum | Minimum |
| 0.51 | 2.2 | 0.1 |

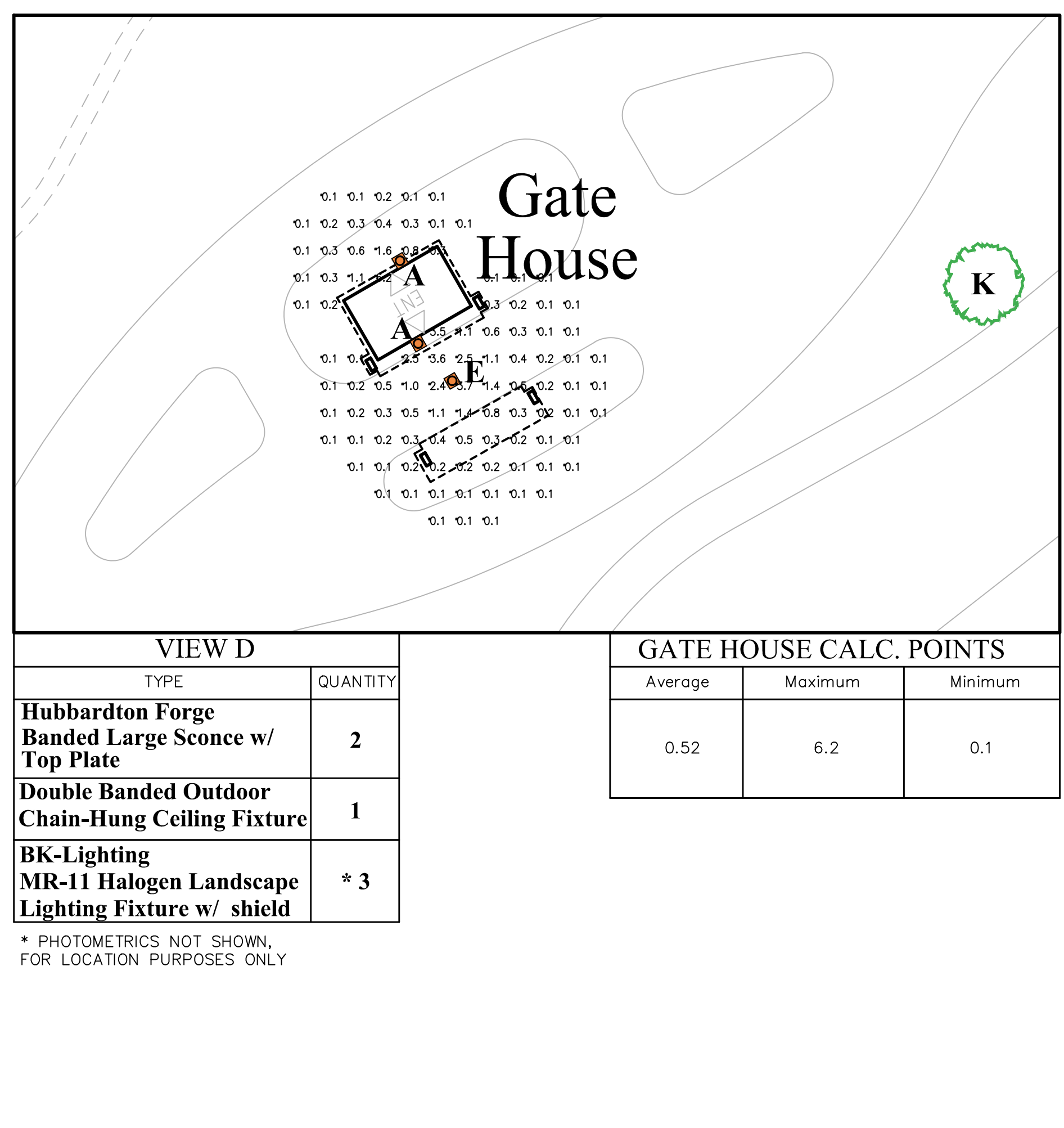

| VIEW D | |
|--|----------|
| TYPE | QUANTITY |
| Hubbardton Forge Banded Large Sconce w/ Top Plate | 2 |
| Double Banded Outdoor Chain-Hung Ceiling Fixture | 1 |
| BK-Lighting MR-11 Halogen Landscape Lighting Fixture w/ shield | * 3 |

| GATE HOUSE CALC. POINTS | | |
|-------------------------|---------|---------|
| Average | Maximum | Minimum |
| 0.52 | 6.2 | 0.1 |

| LIGHT LEGEND | |
|--------------|--|
| Symbol | Description |
| | R7 PATHWAY LIGHTS |
| | MB3 BOLLARD LIGHTS |
| | BANDED LARGE OUTDOOR SCENCE W/ TOP PLATE A MOUNTED AT 6'-6" B MOUNTED AT 7'-6" C MOUNTED AT ±18'-0" D MOUNTED AT ±30'-0" |
| | DOUBLE BANDED OUTDOOR CHAIN-HUNG CEILING FIXTURE MOUNTED AT ±10'-0" |
| | BEACON WALL MOUNT LIGHTS MOUNTED AT 6'-6" F MOUNTED AT 6'-6" G MOUNTED AT 7'-6" H MOUNTED AT 10'-0" |
| | SQUARE GOLD STAR UPLIGHT |
| | TREES W/ ACCENT LIGHT FIXTURES J TWO ACCENT LIGHTS K THREE ACCENT LIGHTS |

OWNER:
Silo Ridge Ventures, LLC
5021 Route 44
Amenia, New York 12501
845.373.8020

ARCHITECTS, PLANNERS, LANDSCAPE ARCHITECTS:
HART | HOWERTON

10 East 40th Street New York, NY 10016
Tel: 212 683 5631 Fax: 212 481 3768
Email: NY@hart-howerton.com

GOLF COURSE DESIGNERS:
FAZIO DESIGN
401 N. Main St., Ste. 400
Hendersonville, North Carolina 28792
828.693.0052 • FAX 828.693.0071

ENVIRONMENTAL PLANNING & CIVIL ENGINEERING:
VHB
Engineering, Surveying & Landscape Architecture, PC
Planning
Transportation
Land Development
Environmental Services
50 Main Street, Suite 360
White Plains, New York 10606
914.467.6600 • FAX 914.761.3759

WASTEWATER AND WATER DESIGN:
CEDARWOOD SERVICES, PLLC
CIVIL & ENVIRONMENTAL ENGINEERING
8-12 Dietz St., Suite 303
Oneonta, NY 10753-8073
248 Main St., PO Box 203
North Creek, NY 51825-5160

PROJECT SURVEYOR:
Kirk K. Horton, Land Surveyor
NYS License No. 049954
9 Broadway
Amenia, New York 12501
845.373.7809

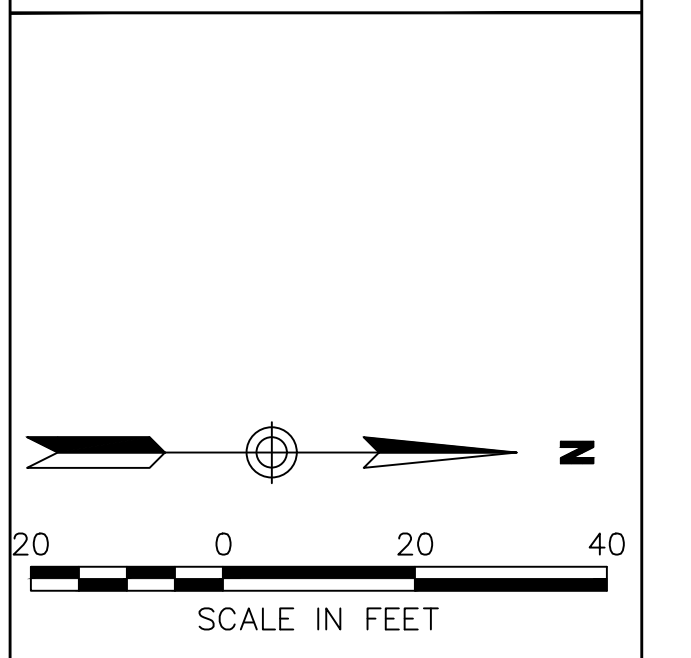
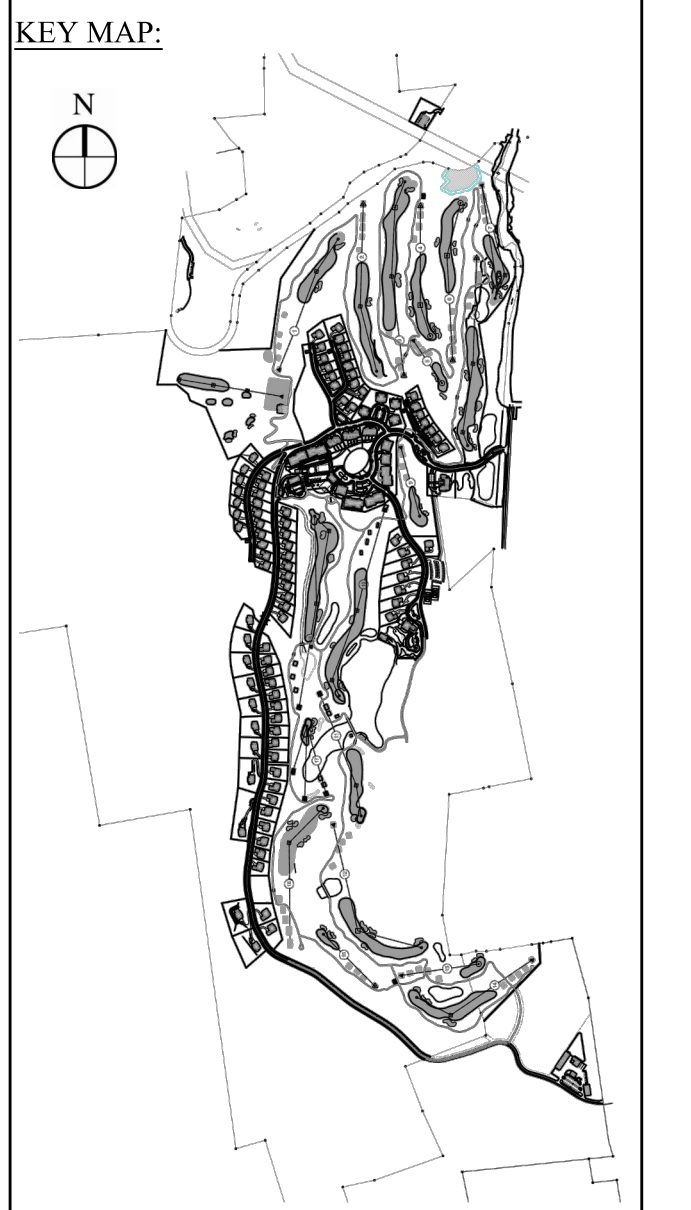

| No. | Revision | Date | By |
|-----|----------|------|----|
| | | | |
| | | | |
| | | | |
| | | | |

Silo Ridge Resort Community
4651 Route 22
Amenia, New York

Project Title: Site Plan - Phase I

Not Issued for Construction
Drawing Title: Lighting Plan Views A Through D

Project Number: **SL1.01**
Sheet of: **1**
Project Number: 29011.00

Matchline

Matchline

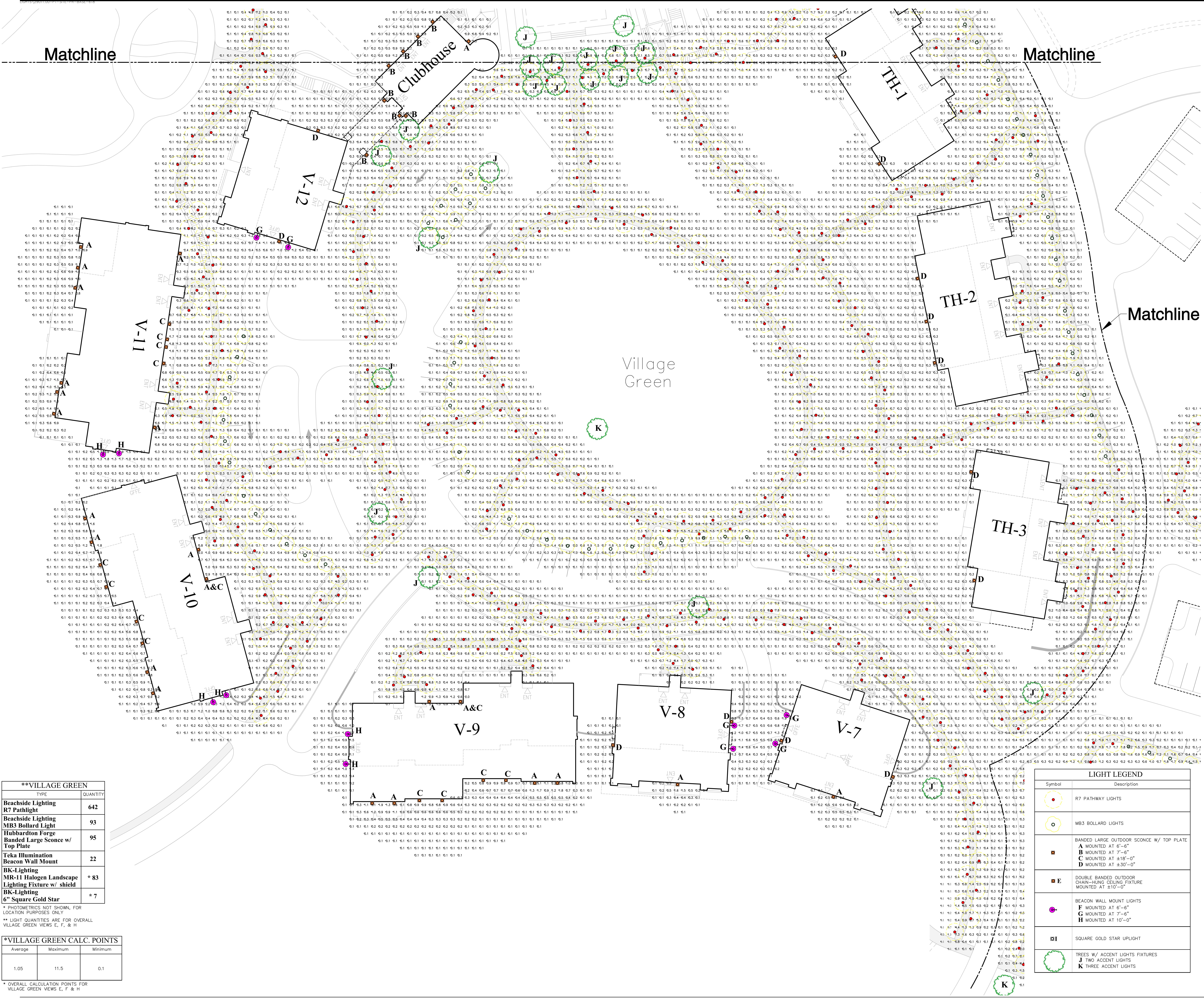

OWNER:
Silo Ridge Ventures, LLC
3021 Route 44
Amenia, New York 12501
845.373.8020

ARCHITECTS, PLANNERS, LANDSCAPE ARCHITECTS:
HART HOWERTON
10 East 40th Street, New York, NY 10016
Tel: 212.683.1631 Fax: 212.481.3768
Email: N.Y.H@howerton.com

GOLF COURSE DESIGNERS:
FAZIO DESIGN
401 N. Main St., Ste. 400
Hendersonville, North Carolina 28792
828.693.0052 • FAX 828.693.0071

ENVIRONMENTAL PLANNING & CIVIL ENGINEERING:
VHB
Engineering, Surveying & Landscape Architecture, PC
Planning
Transportation
Land Development
Environmental Services
50 Main Street, Suite 360
White Plains, New York 10606
914.467.6600 • FAX 914.761.3759

WASTEWATER AND WATER DESIGN:
CEDARWOOD ENGINEERING SERVICES, PLLC
CIVIL & ENVIRONMENTAL ENGINEERING
8-12 Dine St., Suite 303
Oswego, NY 14027-3003
248 Main St., PO Box 203
North Creek, NY 51825-5160

PROJECT SURVEYOR:
Kirk K. Horton, Land Surveyor
NYS License No. 409954
9 Broadway
Amenia, New York 12501
845.373.7809



****VILLAGE GREEN**

| TYPE | QUANTITY |
|---|----------|
| Beachside Lighting R7 Pathlight | 642 |
| Beachside Lighting MB3 Bollard Light | 93 |
| Hubbardton Forge Banded Large Sconce w/ Top Plate | 95 |
| Teka Illumination Beacon Wall Mount | 22 |
| BK-Lighting MIR-11 Halogen Landscape Lighting Fixture w/ shield | * 83 |
| BK-Lighting 6" Square Gold Star | * 7 |

* PHOTOMETRICS NOT SHOWN, FOR LOCATION PURPOSES ONLY
** LIGHT QUANTITIES ARE FOR OVERALL VILLAGE GREEN VIEWS E, F & H

***VILLAGE GREEN CALC. POINTS**

| Average | Maximum | Minimum |
|---------|---------|---------|
| 1.05 | 11.5 | 0.1 |

* OVERALL CALCULATION POINTS FOR VILLAGE GREEN VIEWS E, F & H

LIGHT LEGEND

| Symbol | Description |
|--------|--|
| | R7 PATHWAY LIGHTS |
| | MB3 BOLLARD LIGHTS |
| | BANDED LARGE OUTDOOR SCONCE W/ TOP PLATE A MOUNTED AT 6'-6" B MOUNTED AT 7'-6" C MOUNTED AT 418"-0" D MOUNTED AT 318"-0" |
| | DOUBLE BANDED OUTDOOR CHAIN-HUNG CEILING FIXTURE MOUNTED AT ±10'-0" |
| | BEACON WALL MOUNT LIGHTS F MOUNTED AT 6'-6" G MOUNTED AT 7'-6" H MOUNTED AT 10'-0" |
| | SQUARE GOLD STAR UPLIGHT |
| | TREES W/ ACCENT LIGHTS FIXTURES J TWO ACCENT LIGHTS K THREE ACCENT LIGHTS |

Silo Ridge Resort Community
4651 Route 22
Amenia, New York
Site Plan - Phase I

Not Issued for Construction

Lighting Plan
Village Green
View E

Project Title: SL1.02
Sheet of: 1
Project Number: 29011.00



| **VILLAGE GREEN | |
|--|----------|
| TYPE | QUANTITY |
| Beachside Lighting R7 Pathlight | 642 |
| Beachside Lighting MB3 Bollard Light | 93 |
| Hubbardton Forge Banded Large Sconce w/ Top Plate | 95 |
| Teka Illumination Beacon Wall Mount | 22 |
| BK-Lighting MR-11 Halogen Landscape Lighting Fixture w/ shield | * 83 |
| BK-Lighting 6" Square Gold Star | * 7 |

| *VILLAGE GREEN CALC. POINTS | | |
|-----------------------------|---------|---------|
| Average | Maximum | Minimum |
| 1.05 | 11.5 | 0.1 |

* PHOTOMETRICS NOT SHOWN, FOR LOCATION PURPOSES ONLY.
** LIGHT QUANTITIES ARE FOR OVERALL VILLAGE GREEN VIEWS E, F, & H

| LIGHT LEGEND | |
|--------------|---|
| Symbol | Description |
| | R7 PATHWAY LIGHTS |
| | MB3 BOLLARD LIGHTS |
| | BANDED LARGE OUTDOOR SCONCE W/ TOP PLATE A MOUNTED AT 6'-6" B MOUNTED AT 7'-6" C MOUNTED AT 8'-0" D MOUNTED AT 8'-0"-0" |
| | DOUBLE BANDED OUTDOOR CHAIN-HUNG CEILING FIXTURE MOUNTED AT 10'-0" |
| | BEACON WALL MOUNT LIGHTS MOUNTED AT 6'-6" F MOUNTED AT 6'-6" G MOUNTED AT 7'-6" H MOUNTED AT 10'-0" |
| | SQUARE GOLD STAR UPLIGHT |
| | TREES W/ ACCENT LIGHTS FIXTURES J TWO ACCENT LIGHTS K THREE ACCENT LIGHTS |

OWNER:
Silo Ridge Ventures, LLC
3021 Route 44
Arden, New York 12501
845.373.8020

ARCHITECTS, PLANNERS, LANDSCAPE ARCHITECTS:
HART | HOWERTON
10 East 40th Street, New York, NY 10016
Tel: 212.683.1631 Fax: 212.481.3768
Email: NY@hart-howerton.com

GOLF COURSE DESIGNERS:
FAZIO DESIGN
401 N. Main St., Ste. 400
Hendersonville, North Carolina 28792
828.693.0052 • FAX 828.693.0071

ENVIRONMENTAL PLANNING & CIVIL ENGINEERING:
VHB
Engineering, Surveying & Landscape Architecture, PC
Planning
Transportation
Land Development
Environmental Services
50 Main Street, Suite 300
White Plains, New York 10606
914.467.6600 • FAX 914.761.3759

WASTEWATER AND WATER DESIGN:
CEDARWOOD ENGINEERING SERVICES, PLLC
CIVIL & ENVIRONMENTAL ENGINEERING
8-12 Diner St., Suite 303
Orangetown, NY 10974-3003
248 Main St., PO Box 203
North Creek, NY 51825-5160

PROJECT SURVEYOR:
Kirk K. Horton, Land Surveyor
NYS License No. 049954
9 Broadway
Arden, New York 12501
845.373.7809

KEY MAP:

SCALE IN FEET:
0 20 40

Revision Table:

| No. | Revision | Date | By | App'd |
|-----|----------|------|----|-------|
| 1 | CS | CS | CS | ACC |

Project Title: **Silo Ridge Resort Community**
4651 Route 22
Arden, New York
Site Plan - Phase I
Not Issued for Construction
Drawing Title: **Lighting Plan Village Green View H**
Drawing Number: **SL1.04**
Sheet of: 1
Project Number: 2901.100

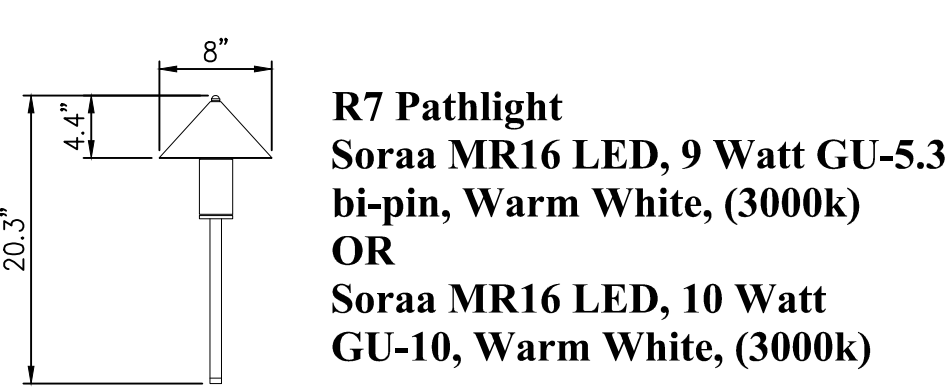

R7 Pathlight
Sora MR16 LED, 9 Watt GU-5.3
bi-pin, Warm White, (3000k)
OR
Sora MR16 LED, 10 Watt
GU-10, Warm White, (3000k)

| * R7 HORIZONTAL FOOTCANDLES AT RADIUS FROM FIXTURE WITH STANDARD 12" STEM HEIGHT | | | | | | | | | | | |
|--|---|-------|-------|-------|-------|-------|-------|-------|-------|-------|--------|
| Symbol | Lamp | 1 ft. | 2 ft. | 3 ft. | 4 ft. | 5 ft. | 6 ft. | 7 ft. | 8 ft. | 9 ft. | 10 ft. |
| | ** (12V AC) 9W or (120V/230V) 10W | 8.44 | 4.5 | 2.75 | 1.65 | 0.9 | 0.53 | 0.37 | 0.28 | 0.22 | 0.17 |

* FOOTCANDLES SHOWN ON PLAN ARE APPROXIMATE AND WERE TAKEN FROM THE ABOVE RADIUS CHART
** REMOTE TRANSFORMER REQUIRED FOR 12V

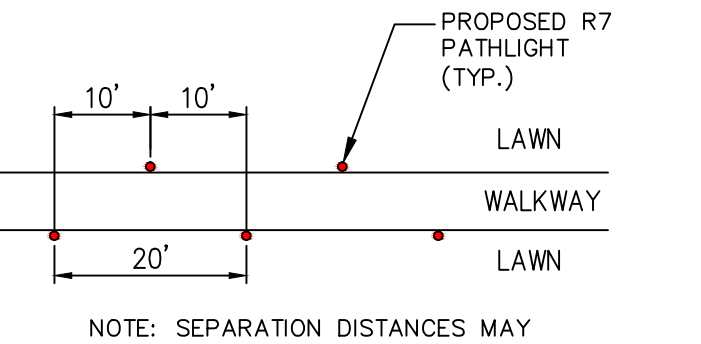

Staggered Layout

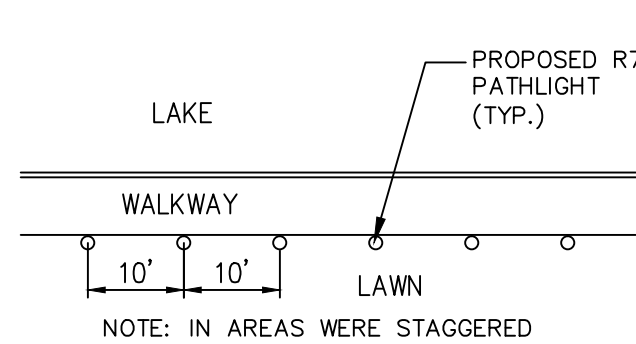

Linear Layout

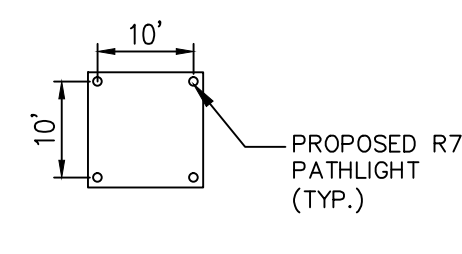

Pathlight Layout at Sales Center Location

BEACHSIDE LIGHTING - R7 PATHLIGHT INFORMATION / VARIOUS LAYOUTS

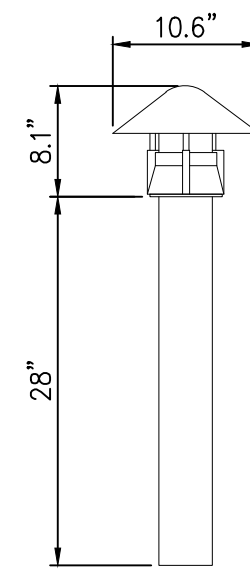

MB3 BOLLARD LIGHT
Sora MR16 LED, 9 Watt GU-5.3
bi-pin, Warm White, (3000k)
OR
Sora MR16 LED, 10 Watt GU-10,
Warm White, (3000k)

| * MB3 PHOTOMETRICS AT RADIUS FROM FIXTURE WITH STANDARD 28" SHAFT HEIGHT | | | | | | | | | | | |
|--|-----------------------------------|-------|-------|-------|-------|-------|-------|-------|-------|-------|--------|
| Symbol | Lamp | 1 ft. | 2 ft. | 3 ft. | 4 ft. | 5 ft. | 6 ft. | 7 ft. | 8 ft. | 9 ft. | 10 ft. |
| | (12V) 9W or (120V/230V) 10W | 0.51 | 1.11 | 1.63 | 1.43 | 1.05 | 0.68 | 0.47 | 0.31 | 0.23 | 0.16 |

* FOOTCANDLES SHOWN ON PLAN ARE APPROXIMATE AND WERE TAKEN FROM THE ABOVE RADIUS CHART

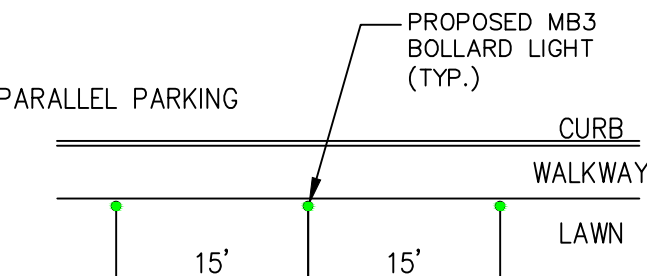

Typical Layout at Parallel Stalls

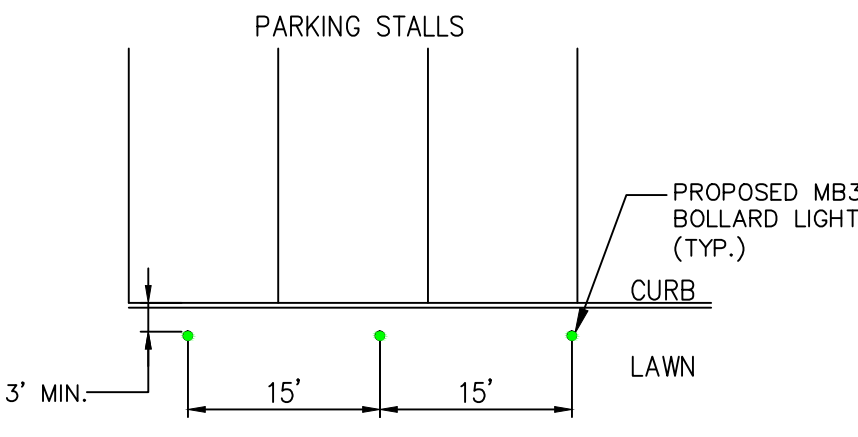

Typical Layout at 90° Stalls

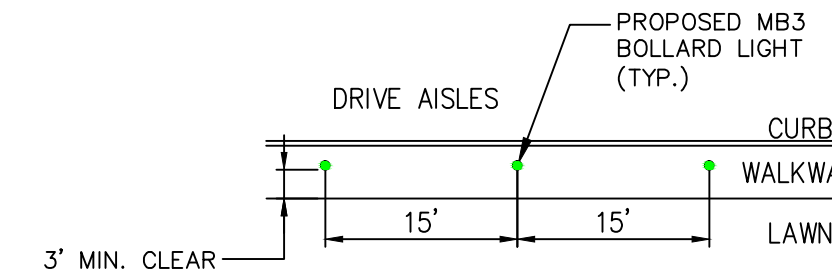

Typical Layout in Sidewalk

BEACHSIDE LIGHTING - MB3 BOLLARD LIGHT INFORMATION

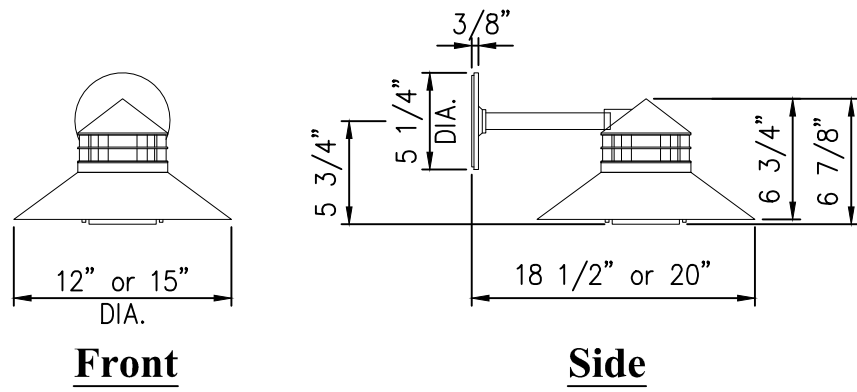

Beacon Wall Mount Compact Fluorescent, 18 Watt GU-24, Warm White, (2700k)
Shade Size: 12 inch or 15 inch

| BEACON WALL MOUNT LAMP DATA | | | | | | | |
|-----------------------------|-------|-------|------------------|------------|----------------|---------------|------------|
| Symbol | Lamp# | Watts | Description | Rated Life | Initial Lumens | Design Lumens | CRI CCT(K) |
| | 355 | 18 | CF18W/GU24/2700K | 10,000 | 1,250 | 1,250 | 82 2,700 |

6" SQUARE GOLD STAR LED Type e23
Light Output (Lumens) - 345
Watts - 8.3
Lumens Per Watt (Efficacy) - 41
CRI - 67
CCT - Bright White (3981k)

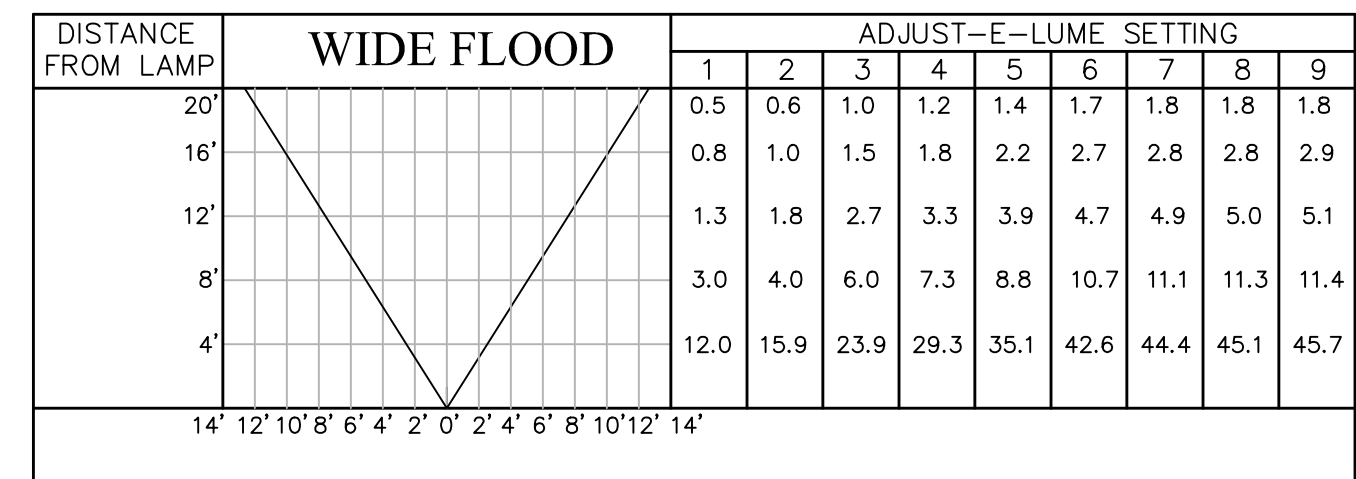
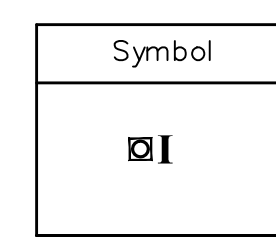
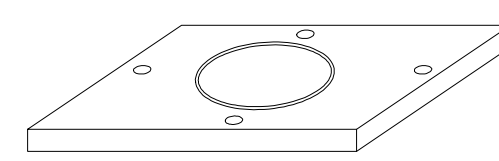

TEKA ILLUMINATION - BEACON WALL MOUNT INFORMATION

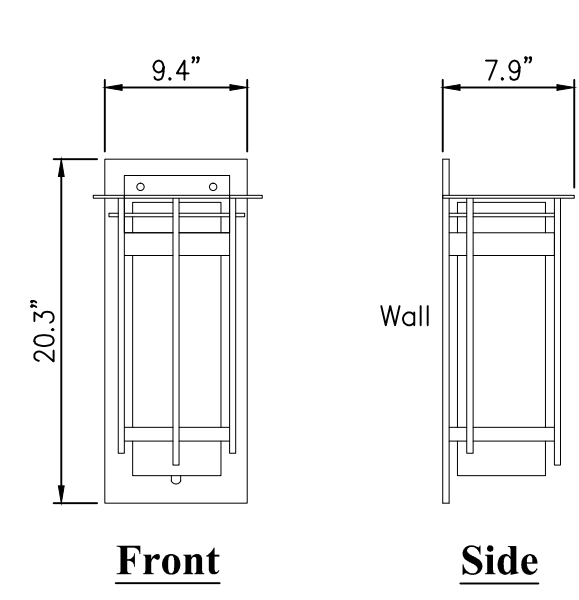

Banded Large Outdoor Sconce with Top Plate - 305994F
Fluorescent, 13 Watt GU-24, 120 Volts

| BANDED LARGE OUTDOOR SCONCE | | | |
|-----------------------------|----------------|-------|----------------|
| Symbol | Lamp# | Watts | Initial Lumens |
| | 305994F-20-G37 | 13 | 1,250 |

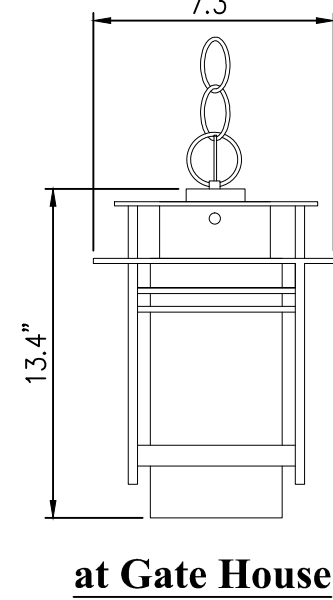

Double Banded - 365796-03-G78
Type A Bulb, 100 Watt max.

HUBBARDTON FORGE - BANDED OUTDOOR WALL SCONCE INFORMATION

DOUBLE BANDED OUTDOOR CHAIN-HUNG CEILING FIXTURE

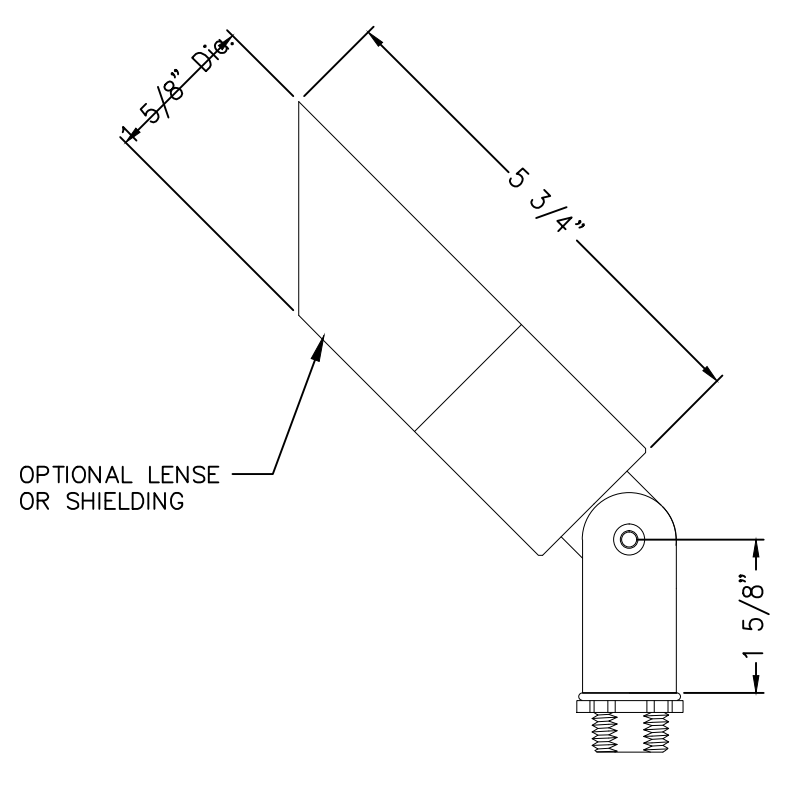

STYLE A - 45°

| MICRO NITE STAR - MR11 | | | | | | | |
|------------------------|-------|-----------|------------|-------------------------|------------|-----------|-------------------|
| Symbol | Watts | ANSI Code | Rated Life | Center Beam Candlepower | Beam Angle | Beam Type | Shielding |
| | 20 | FTD | 2,000 | 700 | 28° | Flood | Honeycomb Baffle* |

* ACCOMMODATES ONLY 2 LENS/SHIELDING MEDIA

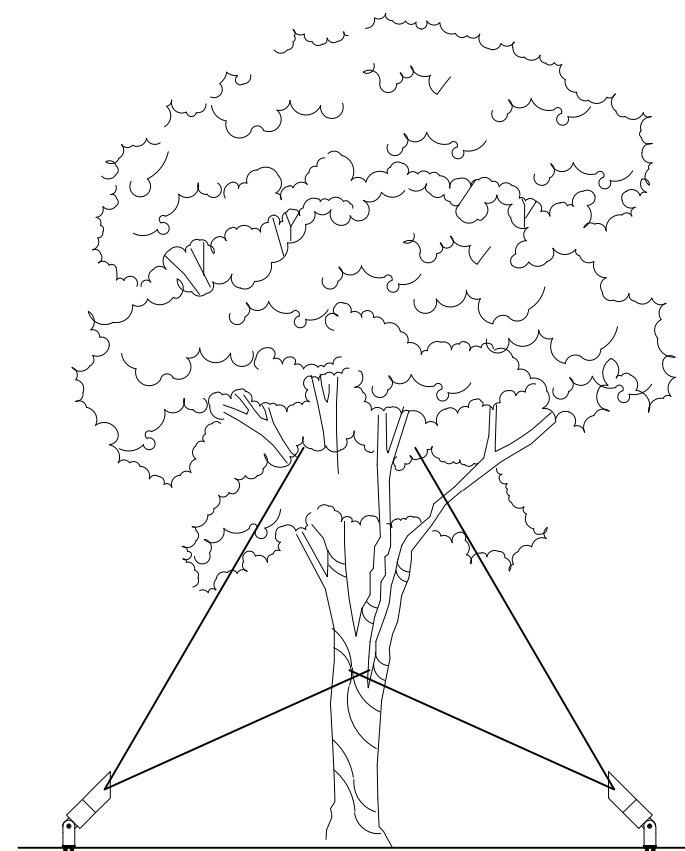

2 Fixture Layout

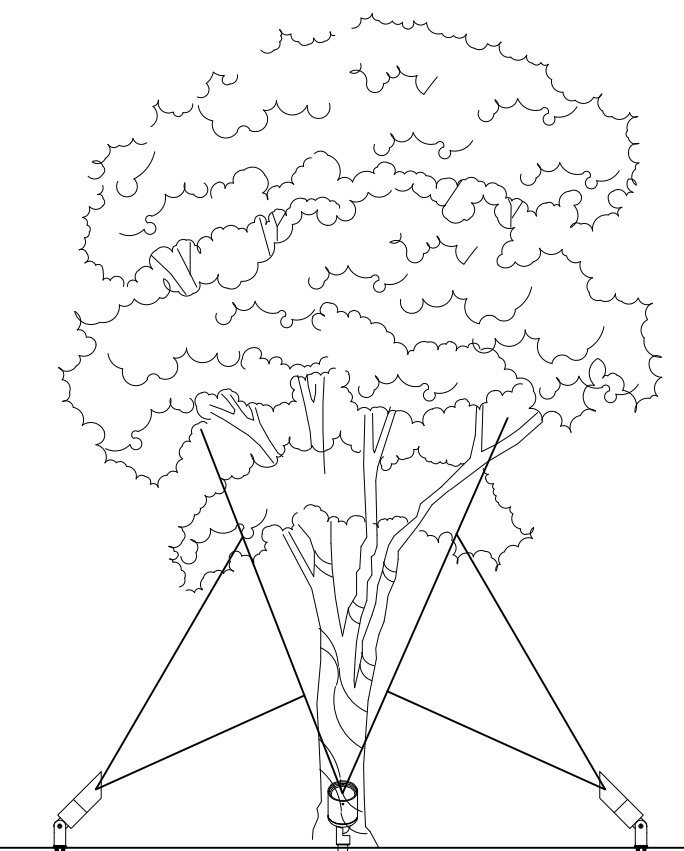

3 Fixture Layout

BK-LIGHTING - UPLIGHT FIXTURE AT POOL LOCATIOS

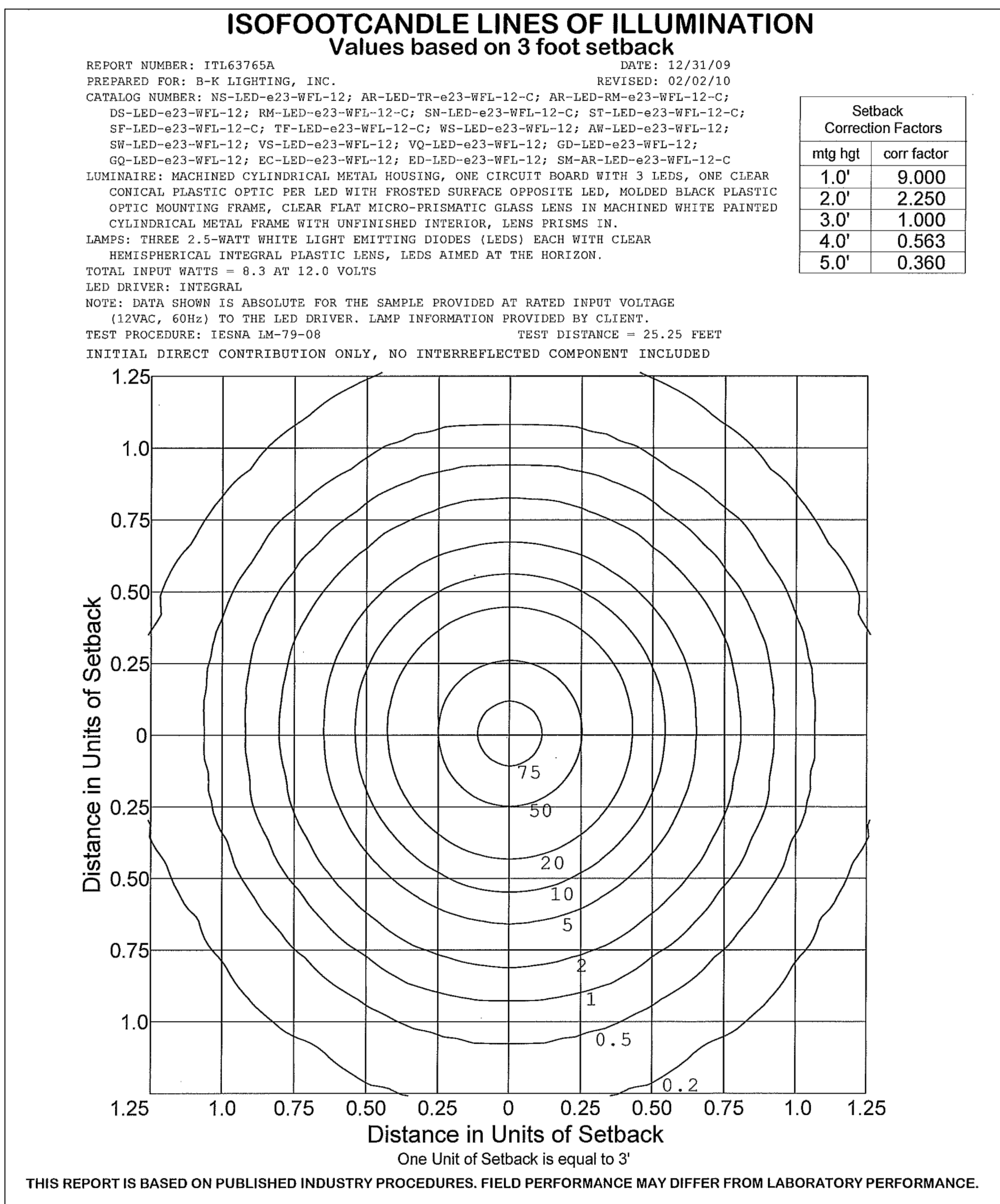

THIS REPORT IS BASED ON PUBLISHED INDUSTRY PROCEDURES. FIELD PERFORMANCE MAY DIFFER FROM LABORATORY PERFORMANCE.

| REPORT NUMBER: ITL63765 | | DATE: 12/31/09 | |
|----------------------------------|----|-------------------|----------|
| PREPARED FOR: B-K LIGHTING, INC. | | REVISED: 02/02/10 | |
| LUMEN TABULATION - FIELD ONLY | | | |
| PAGE 5 | | | |
| AVERAGE OF RIGHT AND LEFT SIDES | | | |
| 50 | 2 | 4 | 0.0 |
| 40 | 2 | 4 | 0.0 |
| 30 | 2 | 4 | 0.0 |
| 20 | 2 | 4 | 0.0 |
| 10 | 2 | 4 | 0.0 |
| 0 | 2 | 4 | 0.0 |
| -10 | 2 | 4 | 0.0 |
| -20 | 2 | 4 | 0.0 |
| -30 | 2 | 4 | 0.0 |
| -40 | 2 | 4 | 0.0 |
| -50 | 2 | 4 | 0.0 |
| -60 | 2 | 4 | 0.0 |
| -70 | 2 | 4 | 0.0 |
| -80 | 2 | 4 | 0.0 |
| -90 | 2 | 4 | 0.0 |
| 50 | 6 | 0.3 | 0.3 |
| 40 | 6 | 0.3 | 0.3 |
| 30 | 6 | 0.3 | 0.3 |
| 20 | 6 | 0.3 | 0.3 |
| 10 | 6 | 0.3 | 0.3 |
| 0 | 6 | 0.3 | 0.3 |
| -10 | 6 | 0.3 | 0.3 |
| -20 | 6 | 0.3 | 0.3 |
| -30 | 6 | 0.3 | 0.3 |
| -40 | 6 | 0.3 | 0.3 |
| -50 | 6 | 0.3 | 0.3 |
| -60 | 6 | 0.3 | 0.3 |
| -70 | 6 | 0.3 | 0.3 |
| -80 | 6 | 0.3 | 0.3 |
| -90 | 6 | 0.3 | 0.3 |
| 50 | 10 | 0.2 | 0.2 |
| 40 | 10 | 0.2 | 0.2 |
| 30 | 10 | 0.2 | 0.2 |
| 20 | 10 | 0.2 | 0.2 |
| 10 | 10 | 0.2 | 0.2 |
| 0 | 10 | 0.2 | 0.2 |
| -10 | 10 | 0.2 | 0.2 |
| -20 | 10 | 0.2 | 0.2 |
| -30 | 10 | 0.2 | 0.2 |
| -40 | 10 | 0.2 | 0.2 |
| -50 | 10 | 0.2 | 0.2 |
| -60 | 10 | 0.2 | 0.2 |
| -70 | 10 | 0.2 | 0.2 |
| -80 | 10 | 0.2 | 0.2 |
| -90 | 10 | 0.2 | 0.2 |
| 50 | 15 | 0.1 | 0.1 |
| 40 | 15 | 0.1 | 0.1 |
| 30 | 15 | 0.1 | 0.1 |
| 20 | 15 | 0.1 | 0.1 |
| 10 | 15 | 0.1 | 0.1 |
| 0 | 15 | 0.1 | 0.1 |
| -10 | 15 | 0.1 | 0.1 |
| -20 | 15 | 0.1 | 0.1 |
| -30 | 15 | 0.1 | 0.1 |
| -40 | 15 | 0.1 | 0.1 |
| -50 | 15 | 0.1 | 0.1 |
| -60 | 15 | 0.1 | 0.1 |
| -70 | 15 | 0.1 | 0.1 |
| -80 | 15 | 0.1 | 0.1 |
| -90 | 15 | 0.1 | 0.1 |
| 50 | 20 | 0.05 | 0.05 |
| 40 | 20 | 0.05 | 0.05 |
| 30 | 20 | 0.05 | 0.05 |
| 20 | 20 | 0.05 | 0.05 |
| 10 | 20 | 0.05 | 0.05 |
| 0 | 20 | 0.05 | 0.05 |
| -10 | 20 | 0.05 | 0.05 |
| -20 | 20 | 0.05 | 0.05 |
| -30 | 20 | 0.05 | 0.05 |
| -40 | 20 | 0.05 | 0.05 |
| -50 | 20 | 0.05 | 0.05 |
| -60 | 20 | 0.05 | 0.05 |
| -70 | 20 | 0.05 | 0.05 |
| -80 | 20 | 0.05 | 0.05 |
| -90 | 20 | 0.05 | 0.05 |
| 50 | 25 | 0.02 | 0.02 |
| 40 | 25 | 0.02 | 0.02 |
| 30 | 25 | 0.02 | 0.02 |
| 20 | 25 | 0.02 | 0.02 |
| 10 | 25 | 0.02 | 0.02 |
| 0 | 25 | 0.02 | 0.02 |
| -10 | 25 | 0.02 | 0.02 |
| -20 | 25 | 0.02 | 0.02 |
| -30 | 25 | 0.02 | 0.02 |
| -40 | 25 | 0.02 | 0.02 |
| -50 | 25 | 0.02 | 0.02 |
| -60 | 25 | 0.02 | 0.02 |
| -70 | 25 | 0.02 | 0.02 |
| -80 | 25 | 0.02 | 0.02 |
| -90 | 25 | 0.02 | 0.02 |
| 50 | 30 | 0.01 | 0.01 |
| 40 | 30 | 0.01 | 0.01 |
| 30 | 30 | 0.01 | 0.01 |
| 20 | 30 | 0.01 | 0.01 |
| 10 | 30 | 0.01 | 0.01 |
| 0 | 30 | 0.01 | 0.01 |
| -10 | 30 | 0.01 | 0.01 |
| -20 | 30 | 0.01 | 0.01 |
| -30 | 30 | 0.01 | 0.01 |
| -40 | 30 | 0.01 | 0.01 |
| -50 | 30 | 0.01 | 0.01 |
| -60 | 30 | 0.01 | 0.01 |
| -70 | 30 | 0.01 | 0.01 |
| -80 | 30 | 0.01 | 0.01 |
| -90 | 30 | 0.01 | 0.01 |
| 50 | 35 | 0.005 | 0.005 |
| 40 | 35 | 0.005 | 0.005 |
| 30 | 35 | 0.005 | 0.005 |
| 20 | 35 | 0.005 | 0.005 |
| 10 | 35 | 0.005 | 0.005 |
| 0 | 35 | 0.005 | 0.005 |
| -10 | 35 | 0.005 | 0.005 |
| -20 | 35 | 0.005 | 0.005 |
| -30 | 35 | 0.005 | 0.005 |
| -40 | 35 | 0.005 | 0.005 |
| -50 | 35 | 0.005 | 0.005 |
| -60 | 35 | 0.005 | 0.005 |
| -70 | 35 | 0.005 | 0.005 |
| -80 | 35 | 0.005 | 0.005 |
| -90 | 35 | 0.005 | 0.005 |
| 50 | 40 | 0.002 | 0.002 |
| 40 | 40 | 0.002 | 0.002 |
| 30 | 40 | 0.002 | 0.002 |
| 20 | 40 | 0.002 | 0.002 |
| 10 | 40 | 0.002 | 0.002 |
| 0 | 40 | 0.002 | 0.002 |
| -10 | 40 | 0.002 | 0.002 |
| -20 | 40 | 0.002 | 0.002 |
| -30 | 40 | 0.002 | 0.002 |
| -40 | 40 | 0.002 | 0.002 |
| -50 | 40 | 0.002 | 0.002 |
| -60 | 40 | 0.002 | 0.002 |
| -70 | 40 | 0.002 | 0.002 |
| -80 | 40 | 0.002 | 0.002 |
| -90 | 40 | 0.002 | 0.002 |
| 50 | 45 | 0.001 | 0.001 |
| 40 | 45 | 0.001 | 0.001 |
| 30 | 45 | 0.001 | 0.001 |
| 20 | 45 | 0.001 | 0.001 |
| 10 | 45 | 0.001 | 0.001 |
| 0 | 45 | 0.001 | 0.001 |
| -10 | 45 | 0.001 | 0.001 |
| -20 | 45 | 0.001 | 0.001 |
| -30 | 45 | 0.001 | 0.001 |
| -40 | 45 | 0.001 | 0.001 |
| -50 | 45 | 0.001 | 0.001 |
| -60 | 45 | 0.001 | 0.001 |
| -70 | 45 | 0.001 | 0.001 |
| -80 | 45 | 0.001 | 0.001 |
| -90 | 45 | 0.001 | 0.001 |
| 50 | 50 | 0.0005 | 0.0005 |
| 40 | 50 | 0.0005 | 0.0005 |
| 30 | 50 | 0.0005 | 0.0005 |
| 20 | 50 | 0.0005 | 0.0005 |
| 10 | 50 | 0.0005 | 0.0005 |
| 0 | 50 | 0.0005 | 0.0005 |
| -10 | 50 | 0.0005 | 0.0005 |
| -20 | 50 | 0.0005 | 0.0005 |
| -30 | 50 | 0.0005 | 0.0005 |
| -40 | 50 | 0.0005 | 0.0005 |
| -50 | 50 | 0.0005 | 0.0005 |
| -60 | 50 | 0.0005 | 0.0005 |
| -70 | 50 | 0.0005 | 0.0005 |
| -80 | 50 | 0.0005 | 0.0005 |
| -90 | 50 | 0.0005 | 0.0005 |
| 50 | 55 | 0.0002 | 0.0002 |
| 40 | 55 | 0.0002 | 0.0002 |
| 30 | 55 | 0.0002 | 0.0002 |
| 20 | 55 | 0.0002 | 0.0002 |
| 10 | 55 | 0.0002 | 0.0002 |
| 0 | 55 | 0.0002 | 0.0002 |
| -10 | 55 | 0.0002 | 0.0002 |
| -20 | 55 | 0.0002 | 0.0002</ |